

BALLROOM ABC

Max Theatre Style - 1027 people

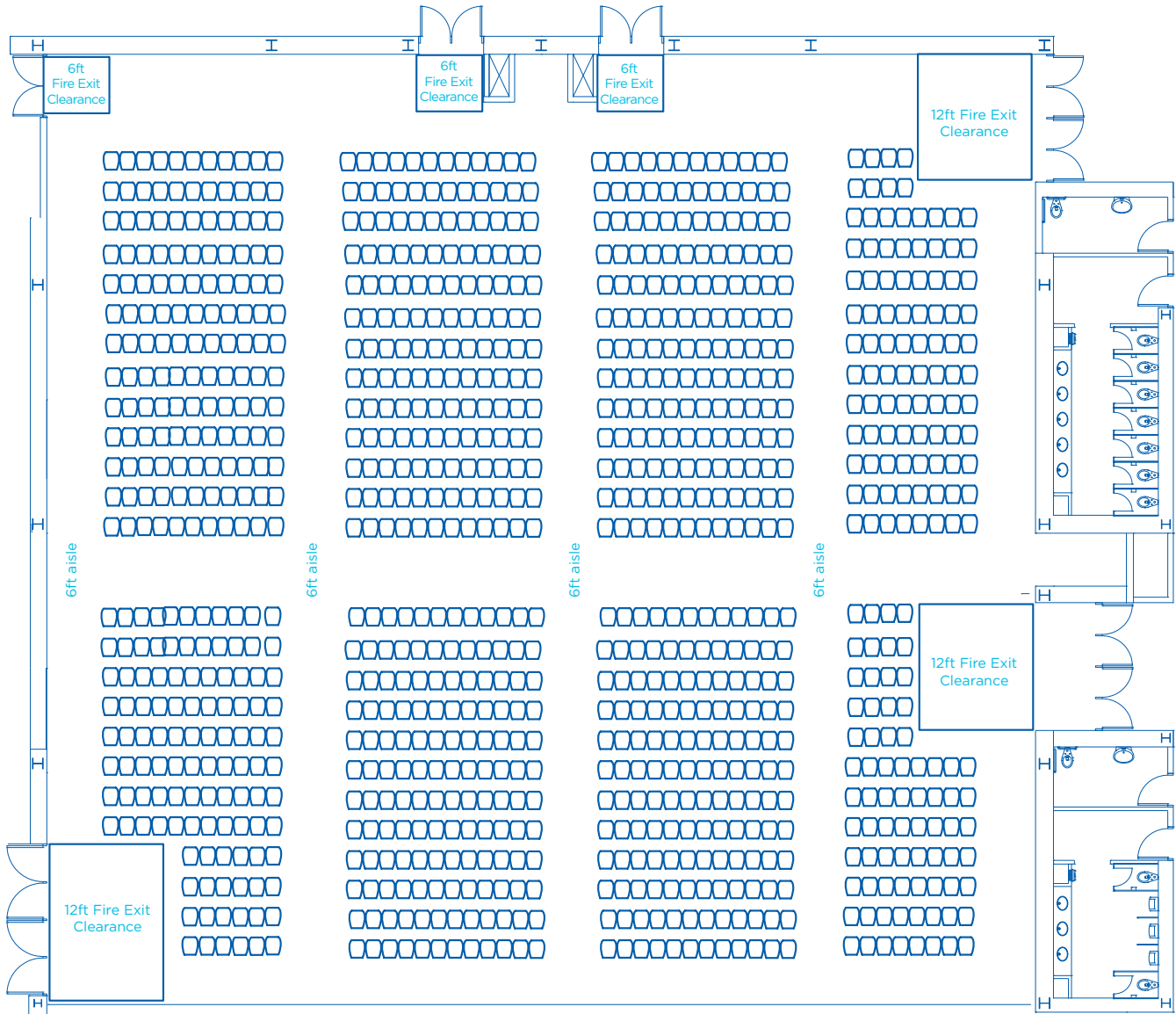

AREA FT ²	AREA M ²	DIMENSIONS FT	CEILING HEIGHT FT	BANQUET 66" OF 10*	RECEPTION*	THEATRE*	CLASSROOM*	BOOTHS 10 x 10*	BOOTHS 8 x 10*
11,240	1,044	108 x 104	23'9"	700	1,400	1,027	572	57	67

*Information listed are maximum 'guest capacities' and may change based on staging, AV equipment, and F&B stations.

plan to be impressed.

Click [here](#) to view all floorplans

BALLROOM ABC

Max Classroom Style - 572 people

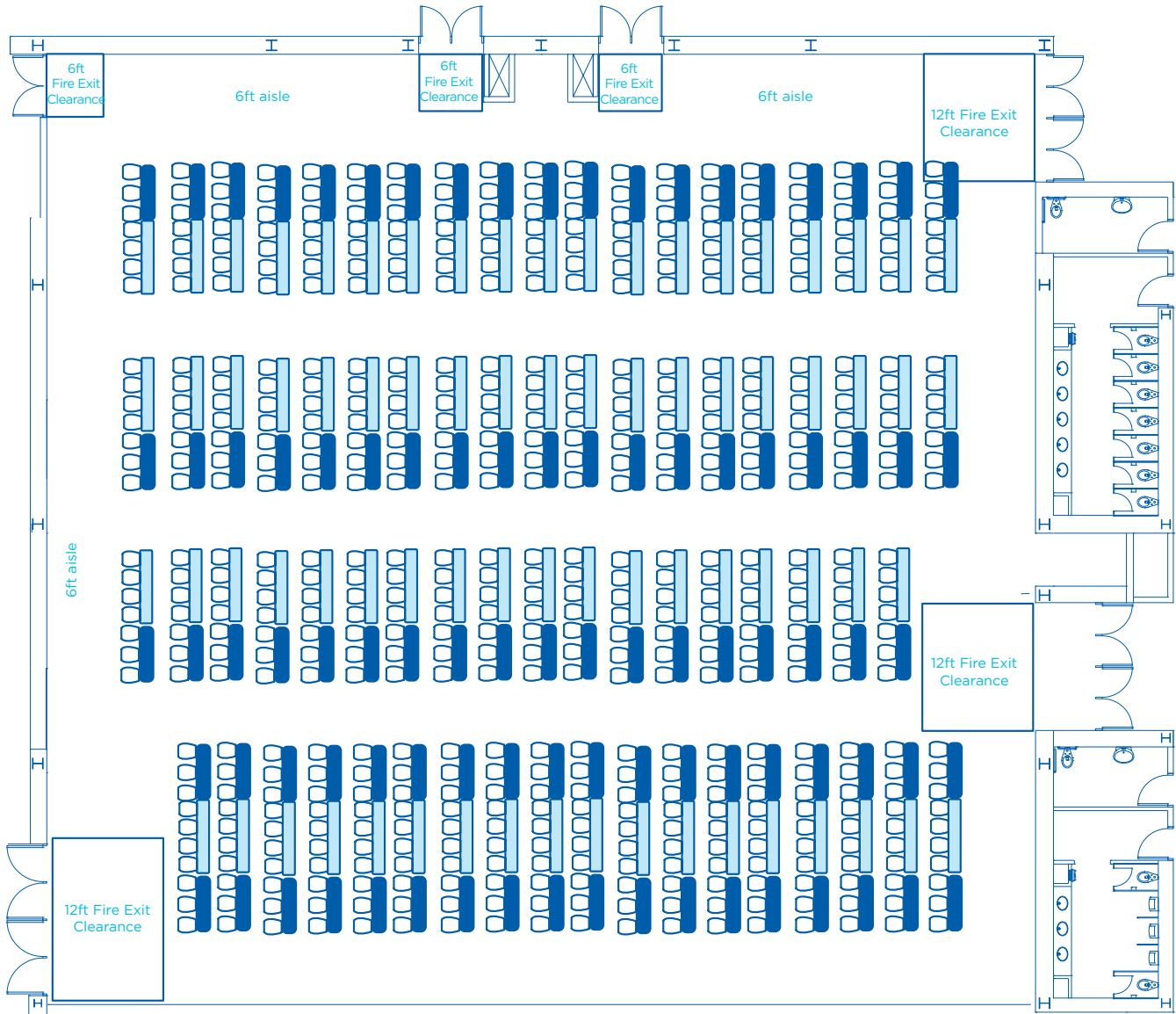

AREA FT ²	AREA M ²	DIMENSIONS FT	CEILING HEIGHT FT	BANQUET 66" OF 10*	RECEPTION*	THEATRE*	CLASSROOM*	BOOTHS 10 x 10*	BOOTHS 8 x 10*
11,240	1,044	108 x 104	23'9"	700	1,400	1,027	572	57	67

*Information listed are maximum 'guest capacities' and may change based on staging, AV equipment, and F&B stations.

plan to be impressed.

Click [here](#) to view all floorplans

BALLROOM ABC

Max 66" Rounds of 10 – 700 people

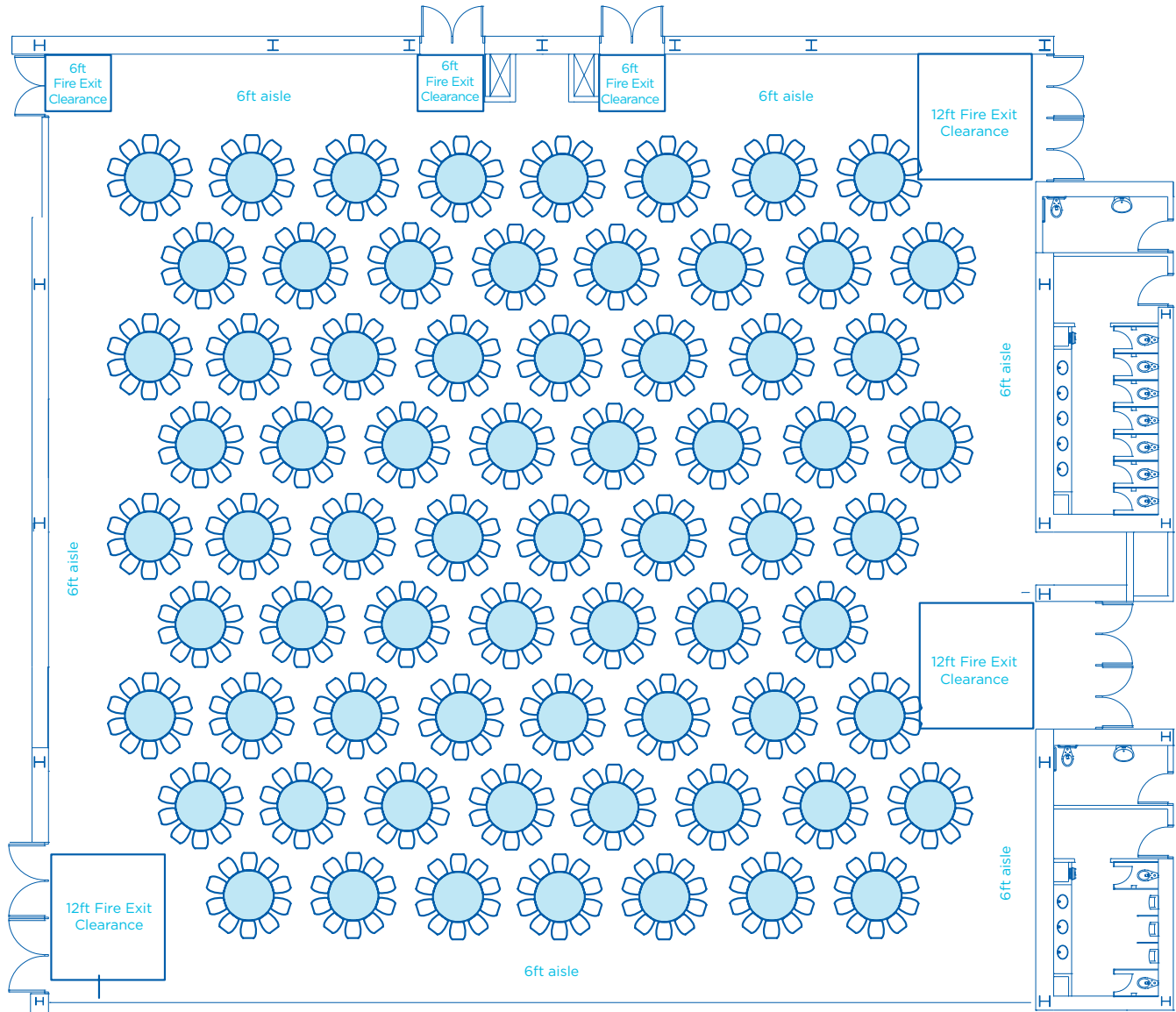

AREA FT ²	AREA M ²	DIMENSIONS FT	CEILING HEIGHT FT	BANQUET 66" OF 10*	RECEPTION*	THEATRE*	CLASSROOM*	BOOTHS 10 x 10*	BOOTHS 8 x 10*
11,240	1,044	108 x 104	23'9"	700	1,400	1,027	572	57	67

*Information listed are maximum 'guest capacities' and may change based on staging, AV equipment, and F&B stations.

plan to be impressed.

Click [here](#) to view all floorplans

BALLROOM ABC

Max 10x10 Booths - 57 booths

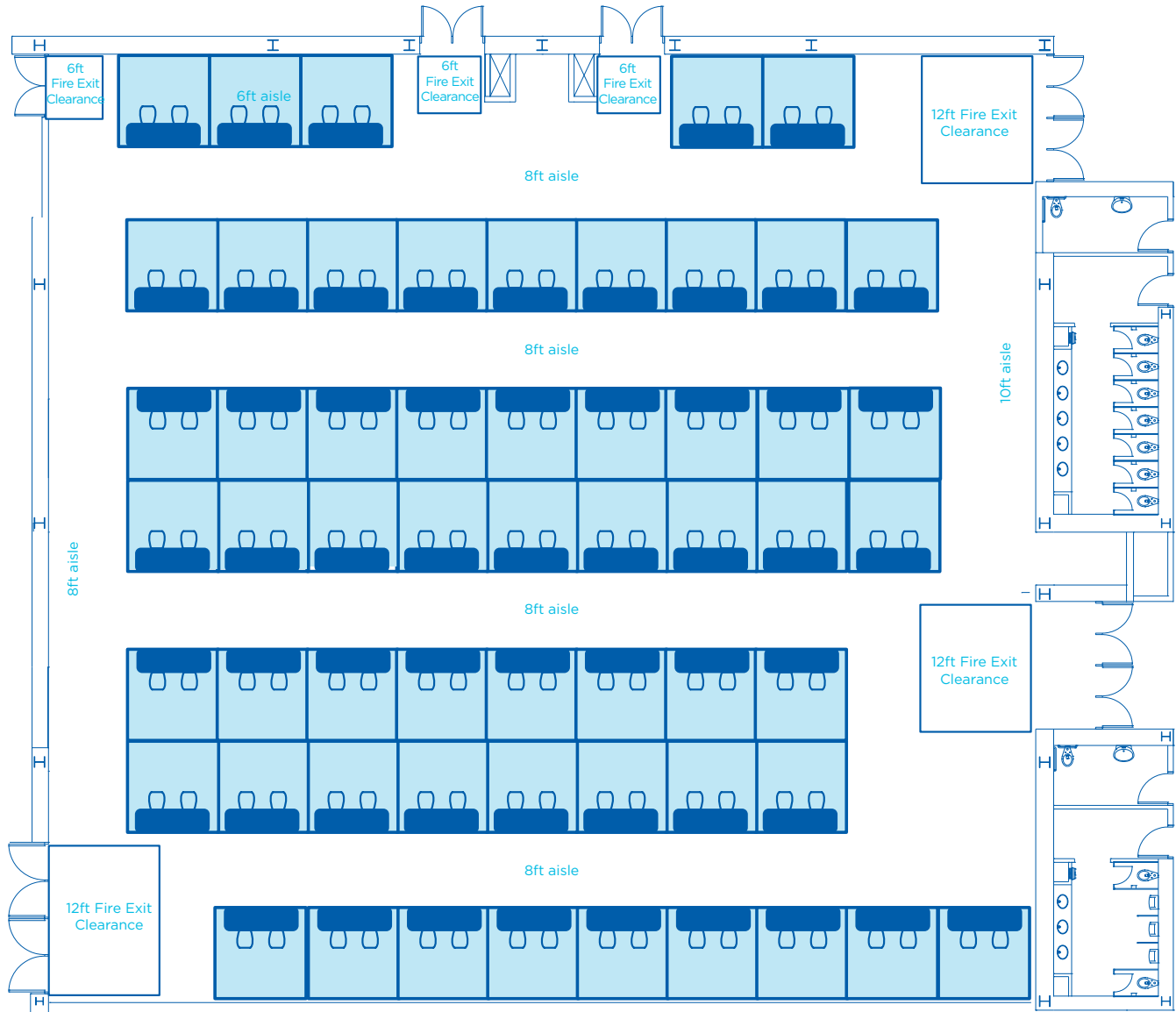

AREA FT ²	AREA M ²	DIMENSIONS FT	CEILING HEIGHT FT	BANQUET 66" OF 10*	RECEPTION*	THEATRE*	CLASSROOM*	BOOTHS 10 x 10*	BOOTHS 8 x 10*
11,240	1,044	108 x 104	23'9"	700	1,400	1,027	572	57	67

*Information listed are maximum 'guest capacities' and may change based on staging, AV equipment, and F&B stations.

plan to be impressed.

Click [here](#) to view all floorplans

BALLROOM ABC

Max 8x10 Booths - 67 booths

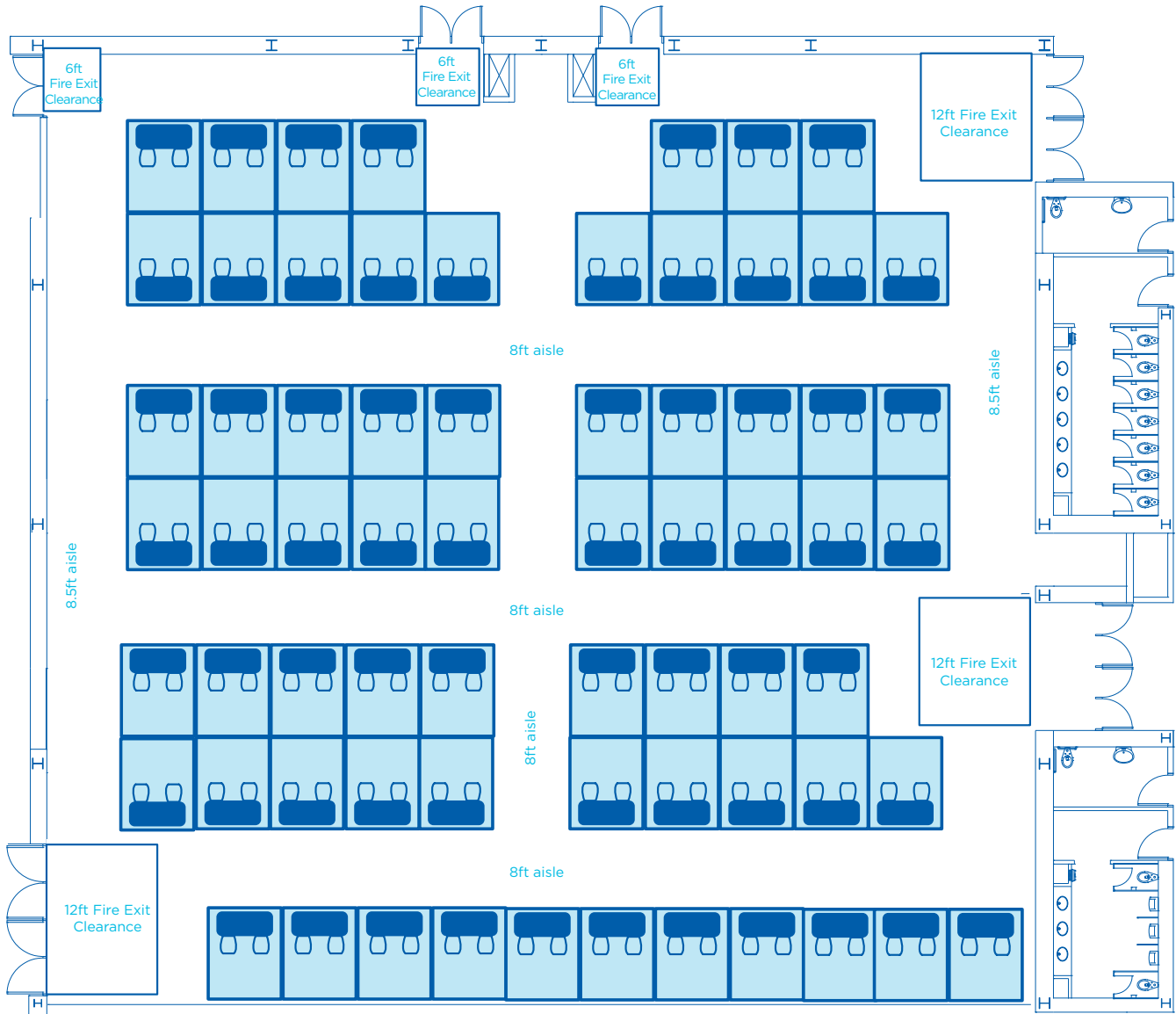

AREA FT ²	AREA M ²	DIMENSIONS FT	CEILING HEIGHT FT	BANQUET 66" OF 10*	RECEPTION*	THEATRE*	CLASSROOM*	BOOTHS 10 x 10*	BOOTHS 8 x 10*
11,240	1,044	108 x 104	23'9"	700	1,400	1,027	572	57	67

*Information listed are maximum 'guest capacities' and may change based on staging, AV equipment, and F&B stations.

plan to be impressed.

Click [here](#) to view all floorplans