

# BALLROOM AB

Max Theatre Style – 555 people

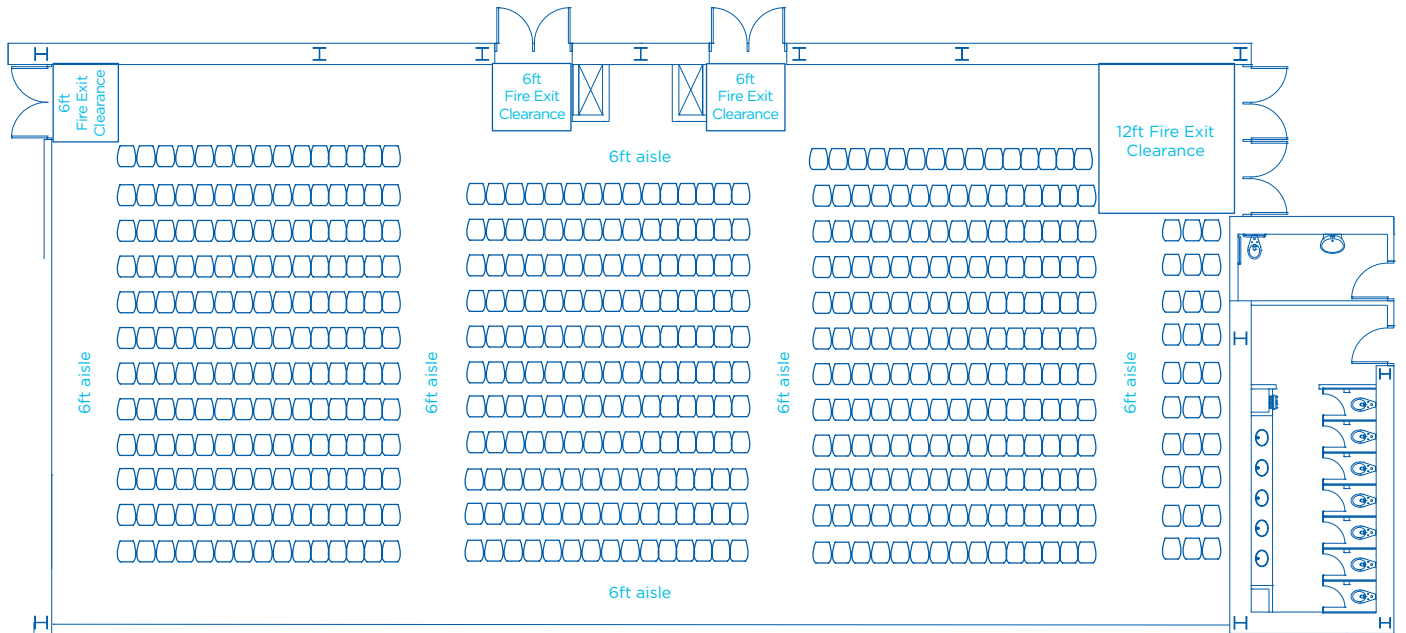

AREA FT <sup>2</sup>	AREA M <sup>2</sup>	DIMENSIONS FT	CEILING HEIGHT FT	BANQUET 66" OF 10*	RECEPTION*	THEATRE*	CLASSROOM*	BOOTHS 10 x 10*	BOOTHS 8 x 10*
5,500	511	108 x 52	23'9"	320	700	555	339	32	31

\*Information listed are maximum 'guest capacities' and may change based on staging, AV equipment, and F&B stations.

**plan to be impressed.**

Click [here](#) to view all floorplans

# BALLROOM AB

Max Classroom Style – 339 people

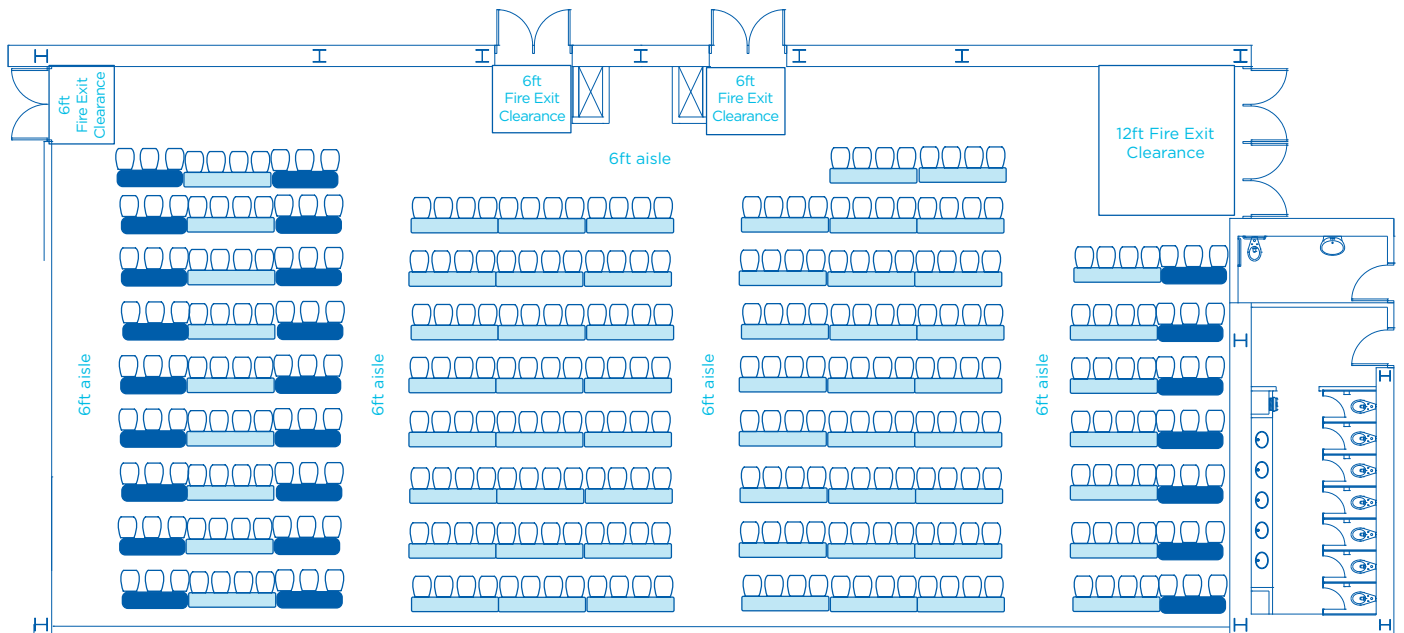

AREA FT <sup>2</sup>	AREA M <sup>2</sup>	DIMENSIONS FT	CEILING HEIGHT FT	BANQUET 66" OF 10*	RECEPTION*	THEATRE*	CLASSROOM*	BOOTHS 10 x 10*	BOOTHS 8 x 10*
5,500	511	108 x 52	23'9"	320	700	555	339	32	31

\*Information listed are maximum 'guest capacities' and may change based on staging, AV equipment, and F&B stations.

**plan to be impressed.**

Click [here](#) to view all floorplans

# BALLROOM AB

Max 66" Rounds of 10 – 320 people

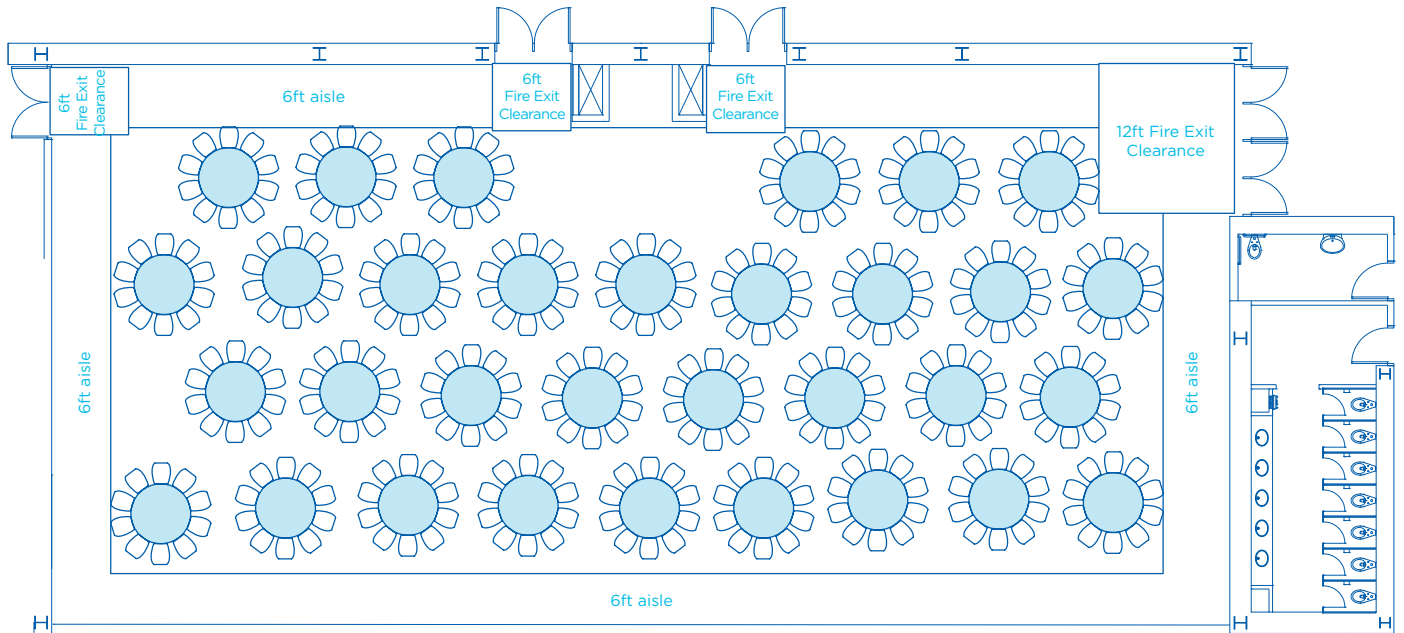

AREA FT <sup>2</sup>	AREA M <sup>2</sup>	DIMENSIONS FT	CEILING HEIGHT FT	BANQUET 66" OF 10*	RECEPTION*	THEATRE*	CLASSROOM*	BOOTHS 10 x 10*	BOOTHS 8 x 10*
5,500	511	108 x 52	23'9"	320	700	555	339	32	31

\*Information listed are maximum 'guest capacities' and may change based on staging, AV equipment, and F&B stations.

**plan to be impressed.**

Click [here](#) to view all floorplans

# BALLROOM AB

Max 10x10 Booths - 32 booths

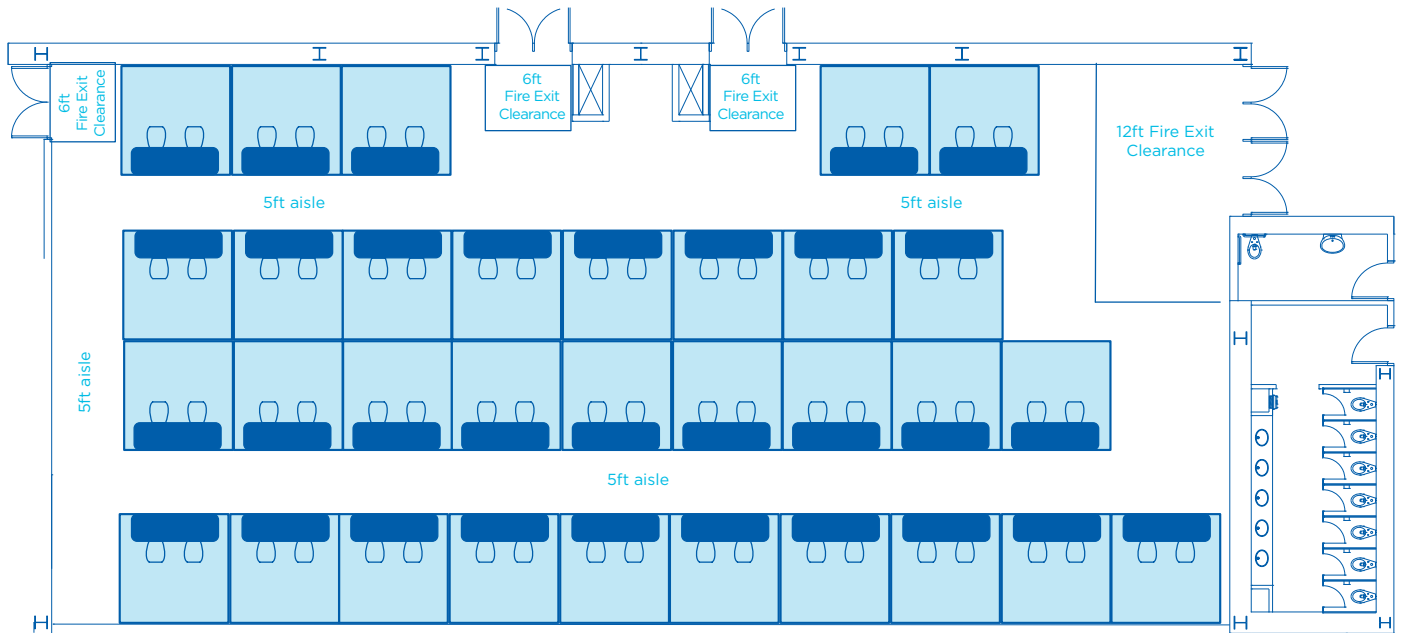

AREA FT <sup>2</sup>	AREA M <sup>2</sup>	DIMENSIONS FT	CEILING HEIGHT FT	BANQUET 66" OF 10*	RECEPTION*	THEATRE*	CLASSROOM*	BOOTHS 10 x 10*	BOOTHS 8 x 10*
5,500	511	108 x 52	23'9"	320	700	555	339	32	31

\*Information listed are maximum 'guest capacities' and may change based on staging, AV equipment, and F&B stations.

**plan to be impressed.**

Click [here](#) to view all floorplans

# BALLROOM AB

Max 8x10 Booths - 31 booths

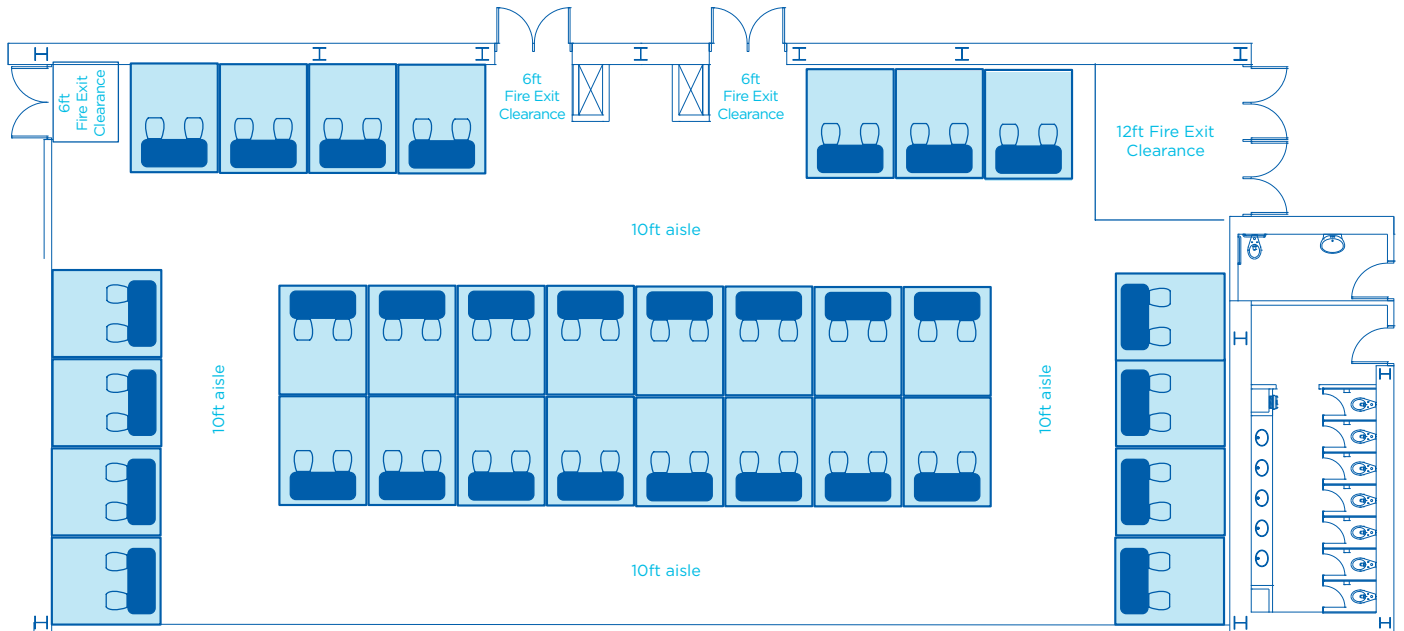

AREA FT <sup>2</sup>	AREA M <sup>2</sup>	DIMENSIONS FT	CEILING HEIGHT FT	BANQUET 66" OF 10*	RECEPTION*	THEATRE*	CLASSROOM*	BOOTHS 10 x 10*	BOOTHS 8 x 10*
5,500	511	108 x 52	23'9"	320	700	555	339	32	31

\*Information listed are maximum 'guest capacities' and may change based on staging, AV equipment, and F&B stations.

**plan to be impressed.**

Click [here](#) to view all floorplans