

BALLROOM A

Max Theatre Style - 222 people

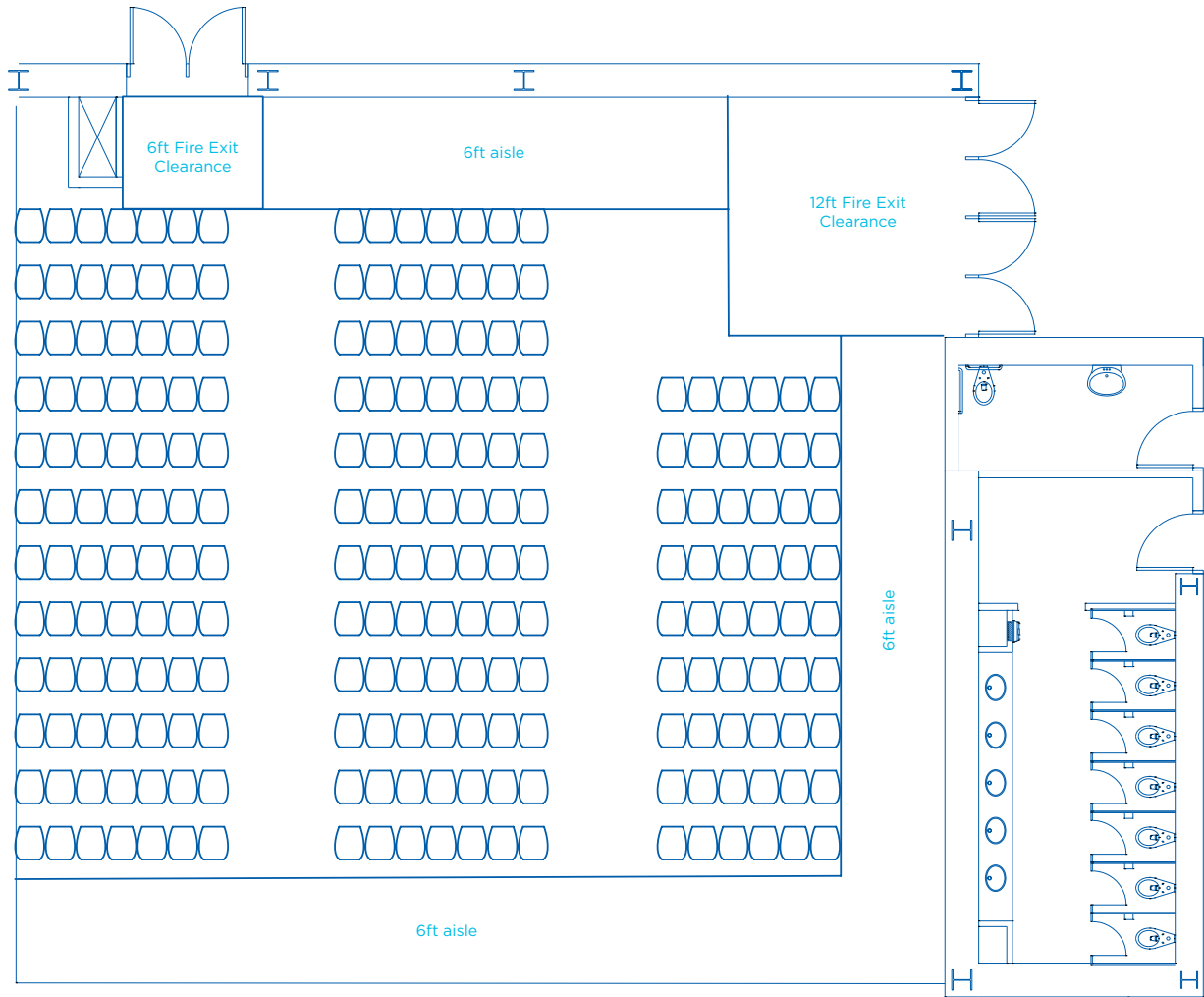

AREA FT ²	AREA M ²	DIMENSIONS FT	CEILING HEIGHT FT	BANQUET 66" OF 10*	RECEPTION*	THEATRE*	CLASSROOM*	BOOTHS 10 x 10*	BOOTHS 8 x 10*
2,750	256	54 x 52	23'9"	140	350	222	154	15	21

*Information listed are maximum 'guest capacities' and may change based on staging, AV equipment, and F&B stations.

plan to be impressed.

Click [here](#) to view all floorplans

BALLROOM A

Max Classroom Style - 154 people

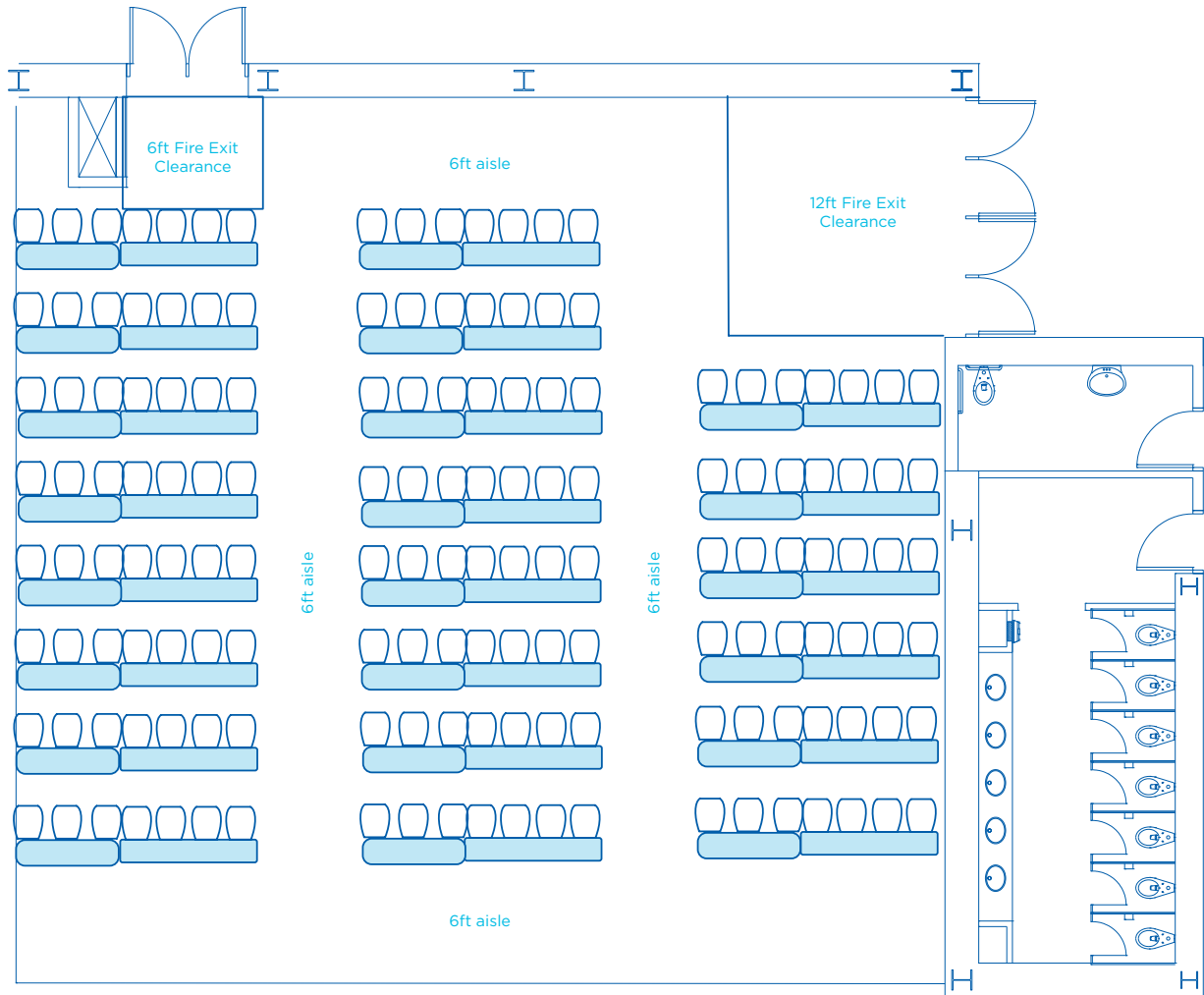

AREA FT ²	AREA M ²	DIMENSIONS FT	CEILING HEIGHT FT	BANQUET 66" OF 10*	RECEPTION*	THEATRE*	CLASSROOM*	BOOTHS 10 x 10*	BOOTHS 8 x 10*
2,750	256	54 x 52	23'9"	140	350	222	154	15	21

*Information listed are maximum 'guest capacities' and may change based on staging, AV equipment, and F&B stations.

plan to be impressed.

Click [here](#) to view all floorplans

BALLROOM A

Max 66" Rounds of 10 – 140 people

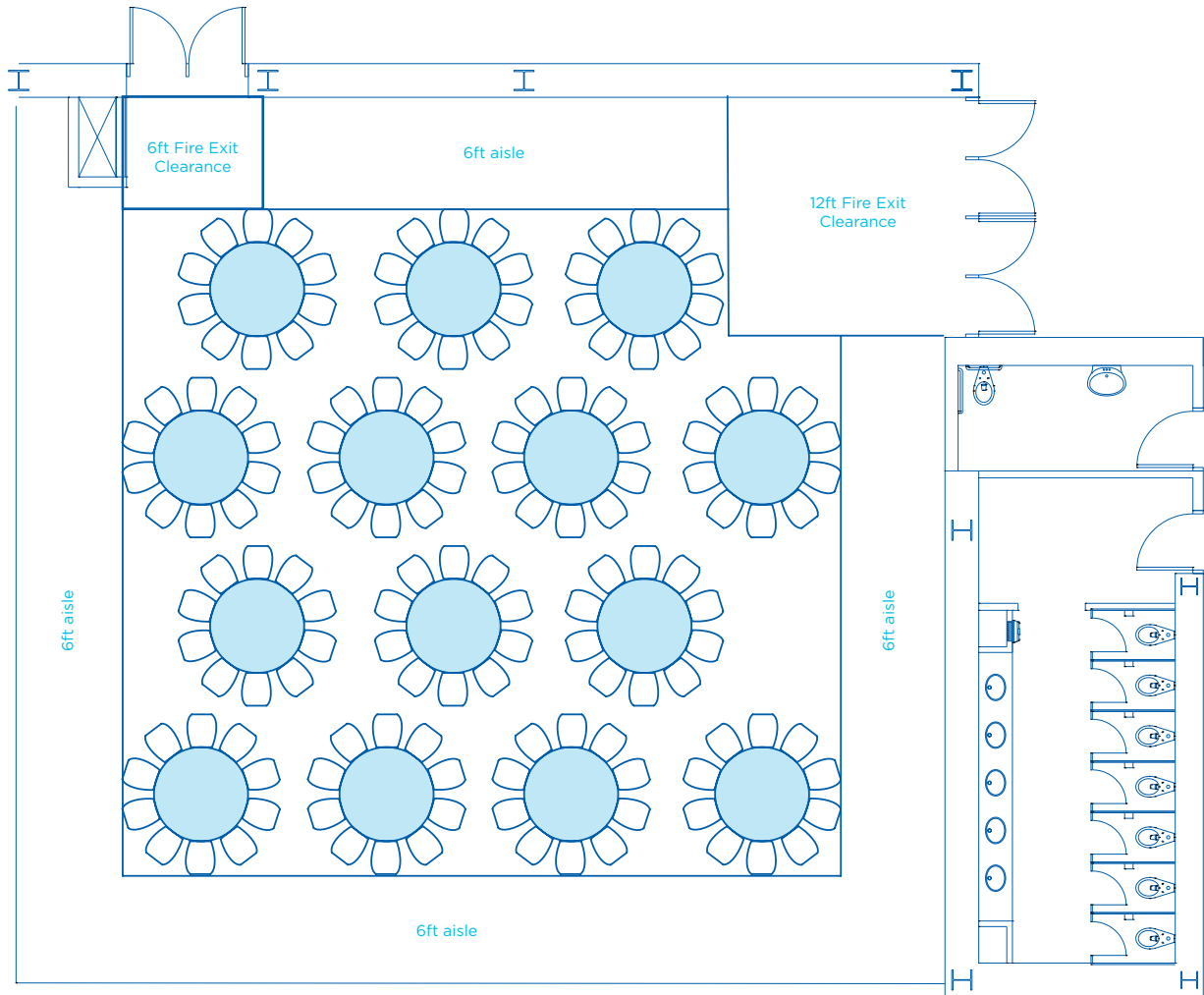

AREA FT ²	AREA M ²	DIMENSIONS FT	CEILING HEIGHT FT	BANQUET 66" OF 10*	RECEPTION*	THEATRE*	CLASSROOM*	BOOTHS 10 x 10*	BOOTHS 8 x 10*
2,750	256	54 x 52	23'9"	140	350	222	154	15	21

*Information listed are maximum 'guest capacities' and may change based on staging, AV equipment, and F&B stations.

plan to be impressed.

Click [here](#) to view all floorplans

BALLROOM A

Max 10x10 Booths - 15 booths

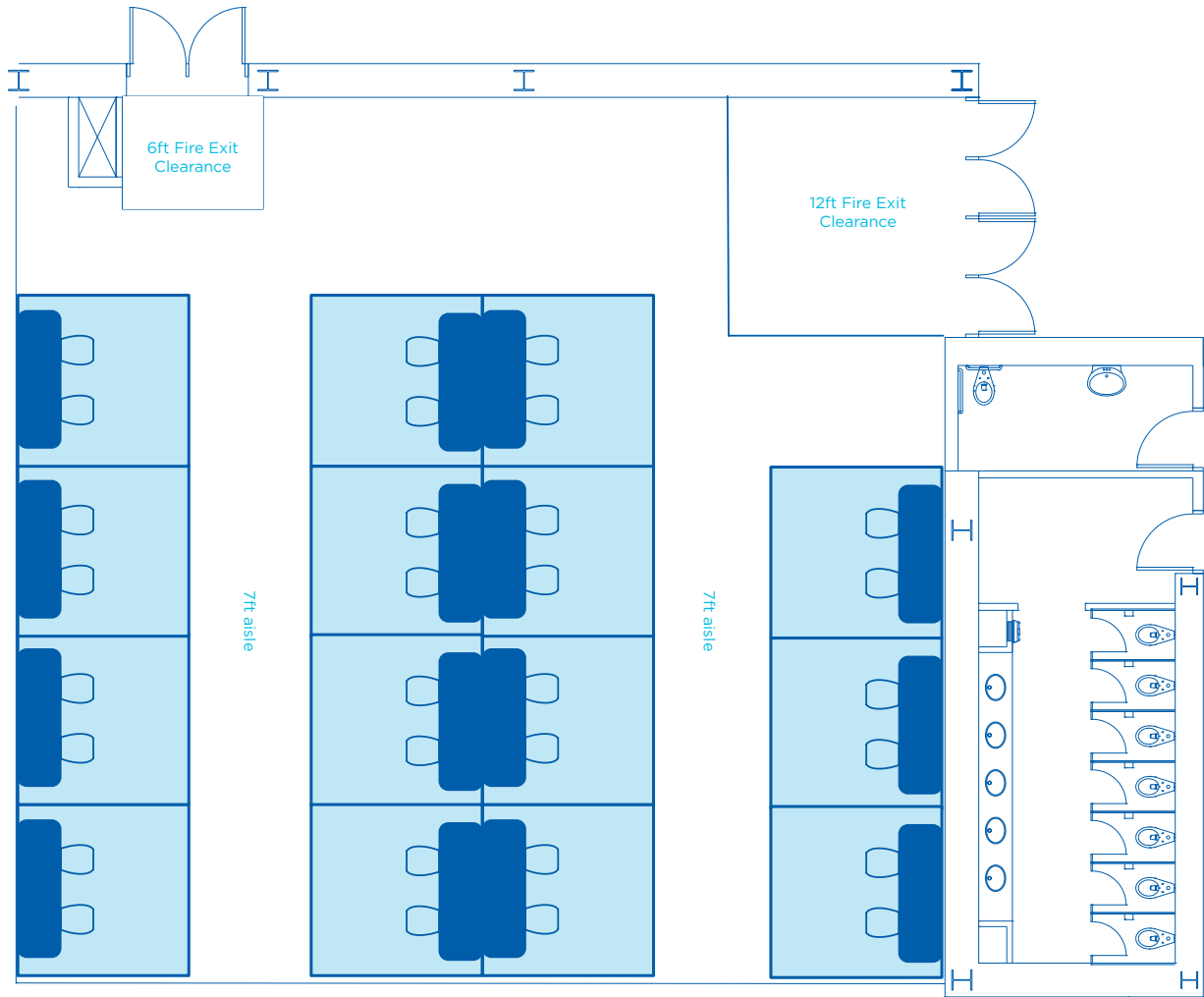

AREA FT ²	AREA M ²	DIMENSIONS FT	CEILING HEIGHT FT	BANQUET 66" OF 10*	RECEPTION*	THEATRE*	CLASSROOM*	BOOTHS 10 x 10*	BOOTHS 8 x 10*
2,750	256	54 x 52	23'9"	140	350	222	154	15	21

*Information listed are maximum 'guest capacities' and may change based on staging, AV equipment, and F&B stations.

plan to be impressed.

Click [here](#) to view all floorplans

BALLROOM A

Max 8x10 Tabletops - 21 booths

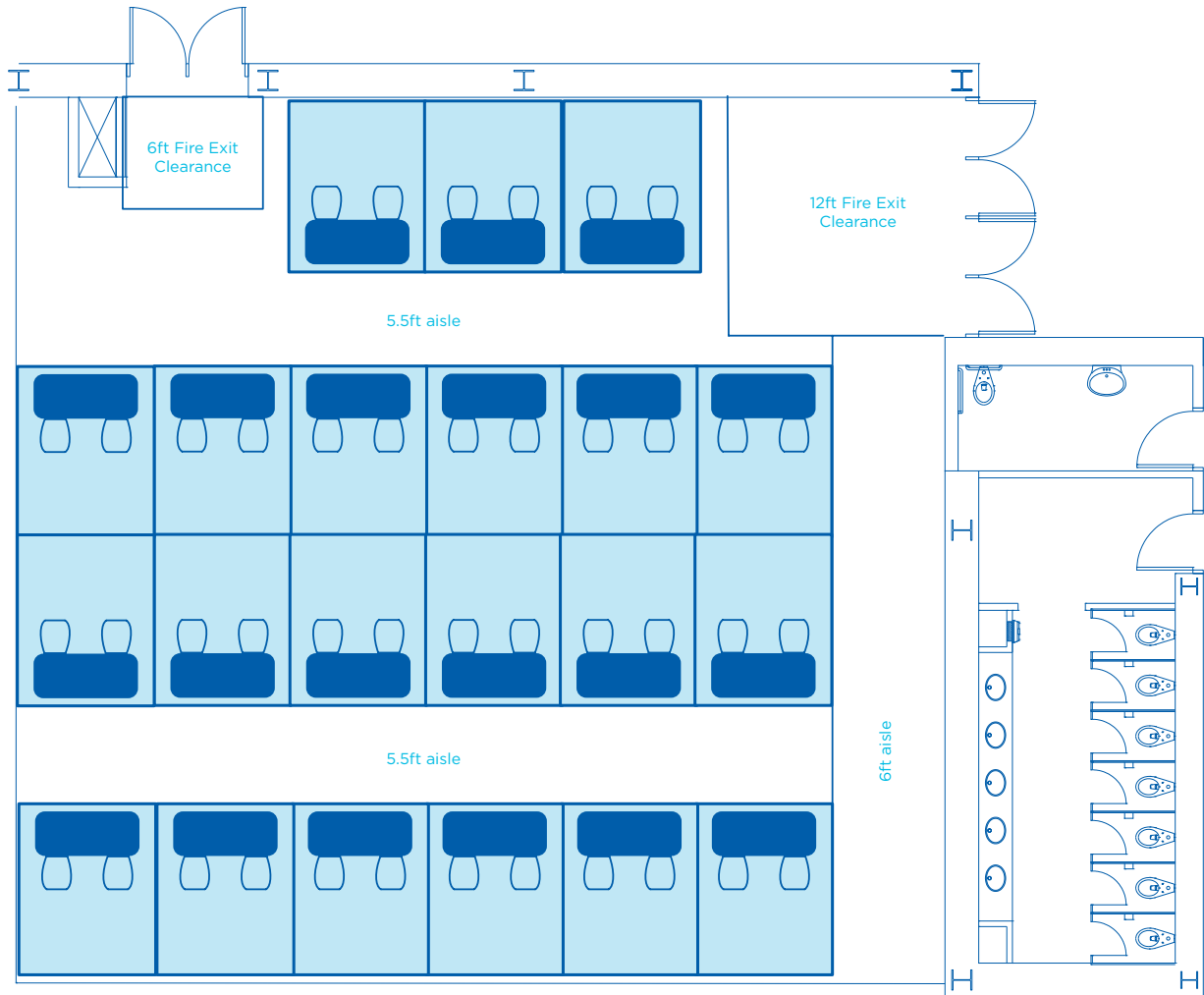

AREA FT ²	AREA M ²	DIMENSIONS FT	CEILING HEIGHT FT	BANQUET 66" OF 10*	RECEPTION*	THEATRE*	CLASSROOM*	BOOTHS 10 x 10*	BOOTHS 8 x 10*
2,750	256	54 x 52	23'9"	140	350	222	154	15	21

*Information listed are maximum 'guest capacities' and may change based on staging, AV equipment, and F&B stations.

plan to be impressed.

Click [here](#) to view all floorplans