

BALLROOM ABCD

Max Theatre Style - 1722 people

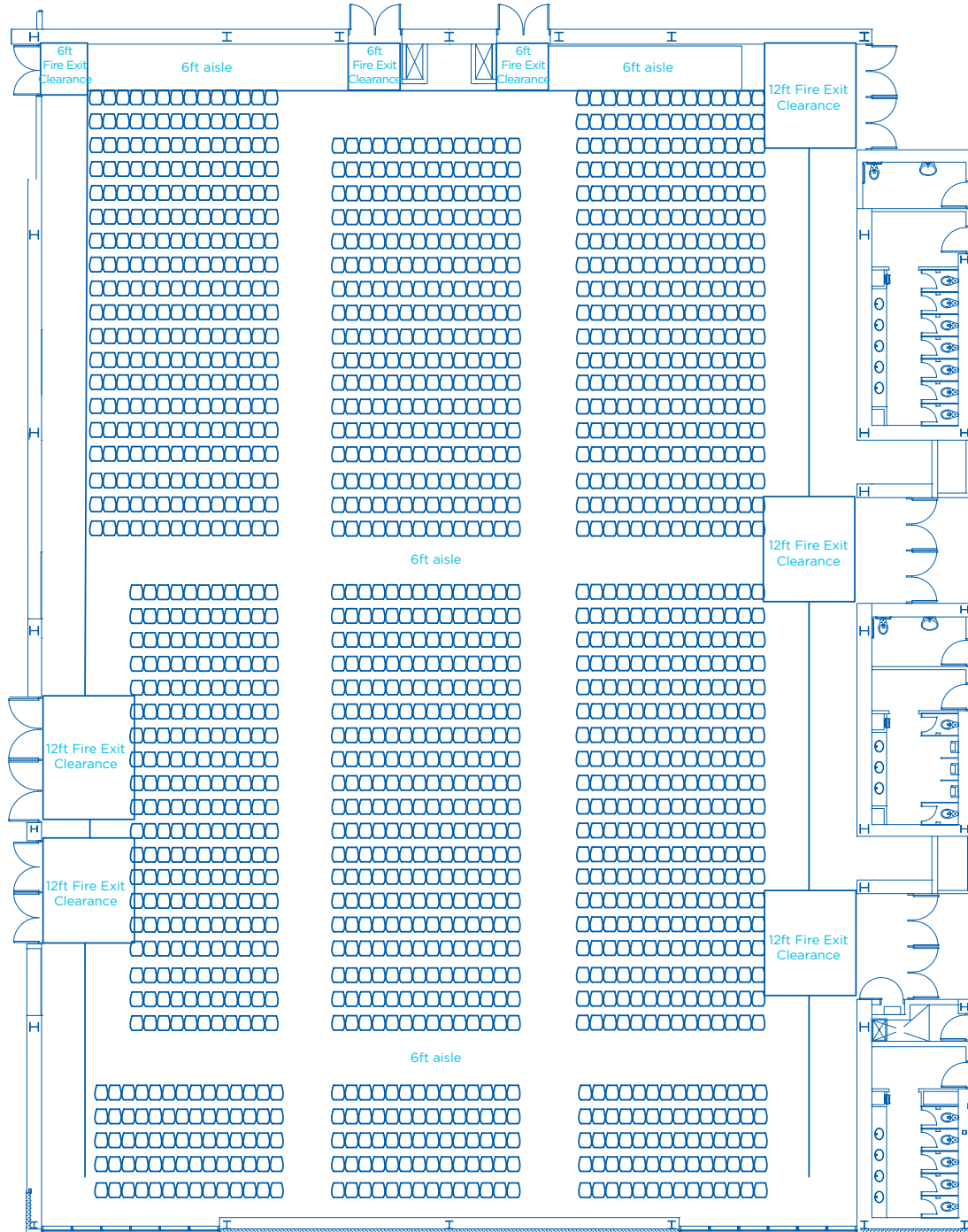

AREA FT ²	AREA M ²	DIMENSIONS FT	CEILING HEIGHT FT	BANQUET 66" OF 10*	RECEPTION*	THEATRE*	CLASSROOM*	BOOTHS 10 x 10*	BOOTHS 8 x 10*
16,955	1,575	108 x 156	23'9"	1,080	2,100	1,722	900	84	92

*Information listed are maximum 'guest capacities' and may change based on staging, AV equipment, and F&B stations.

plan to be impressed.

Click [here](#) to view all floorplans

BALLROOM ABCD

Max Classroom Style - 900 people

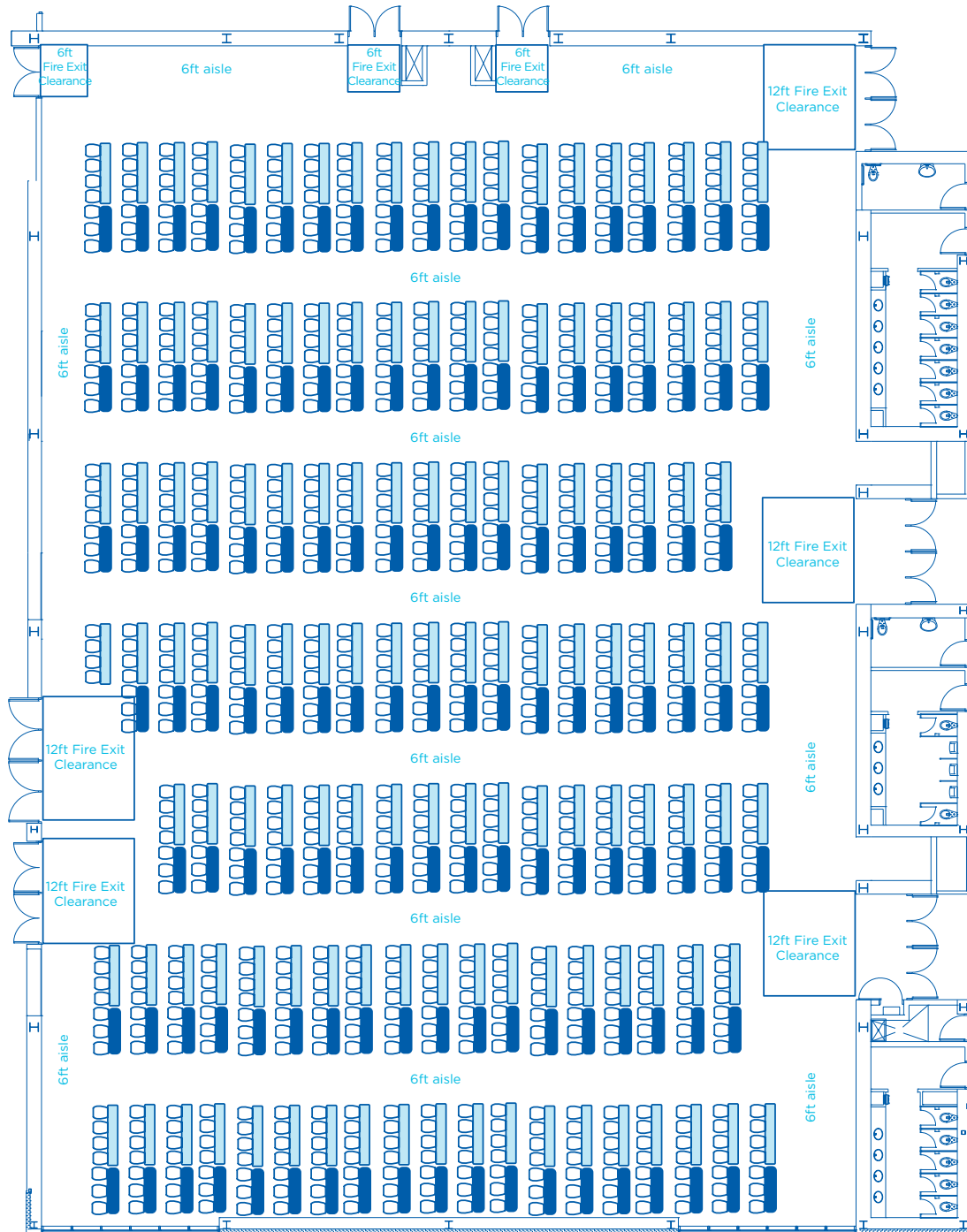

AREA FT ²	AREA M ²	DIMENSIONS FT	CEILING HEIGHT FT	BANQUET 66" OF 10*	RECEPTION*	THEATRE*	CLASSROOM*	BOOTHS 10 x 10*	BOOTHS 8 x 10*
16,955	1,575	108 x 156	23'9"	1,080	2,100	1,722	900	84	92

*Information listed are maximum 'guest capacities' and may change based on staging, AV equipment, and F&B stations.

plan to be impressed.

Click [here](#) to view all floorplans

BALLROOM ABCD

Max 66" Rounds of 10 – 1080 people

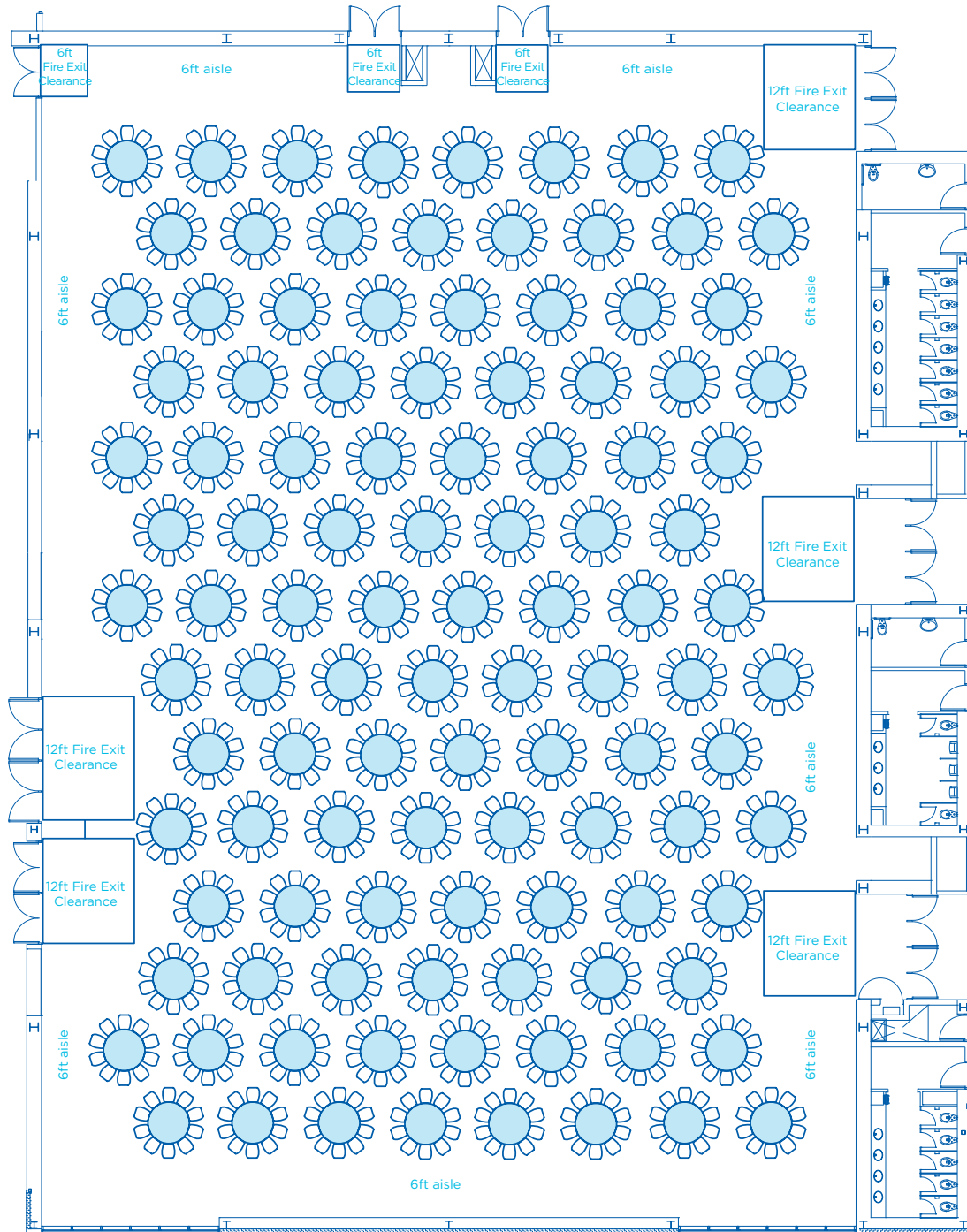

AREA FT ²	AREA M ²	DIMENSIONS FT	CEILING HEIGHT FT	BANQUET 66" OF 10*	RECEPTION*	THEATRE*	CLASSROOM*	BOOTHS 10 x 10*	BOOTHS 8 x 10*
16,955	1,575	108 x 156	23'9"	1,080	2,100	1,722	900	84	92

*Information listed are maximum 'guest capacities' and may change based on staging, AV equipment, and F&B stations.

plan to be impressed.

Click [here](#) to view all floorplans

BALLROOM ABCD

Max 10x10 Booths - 84 booths

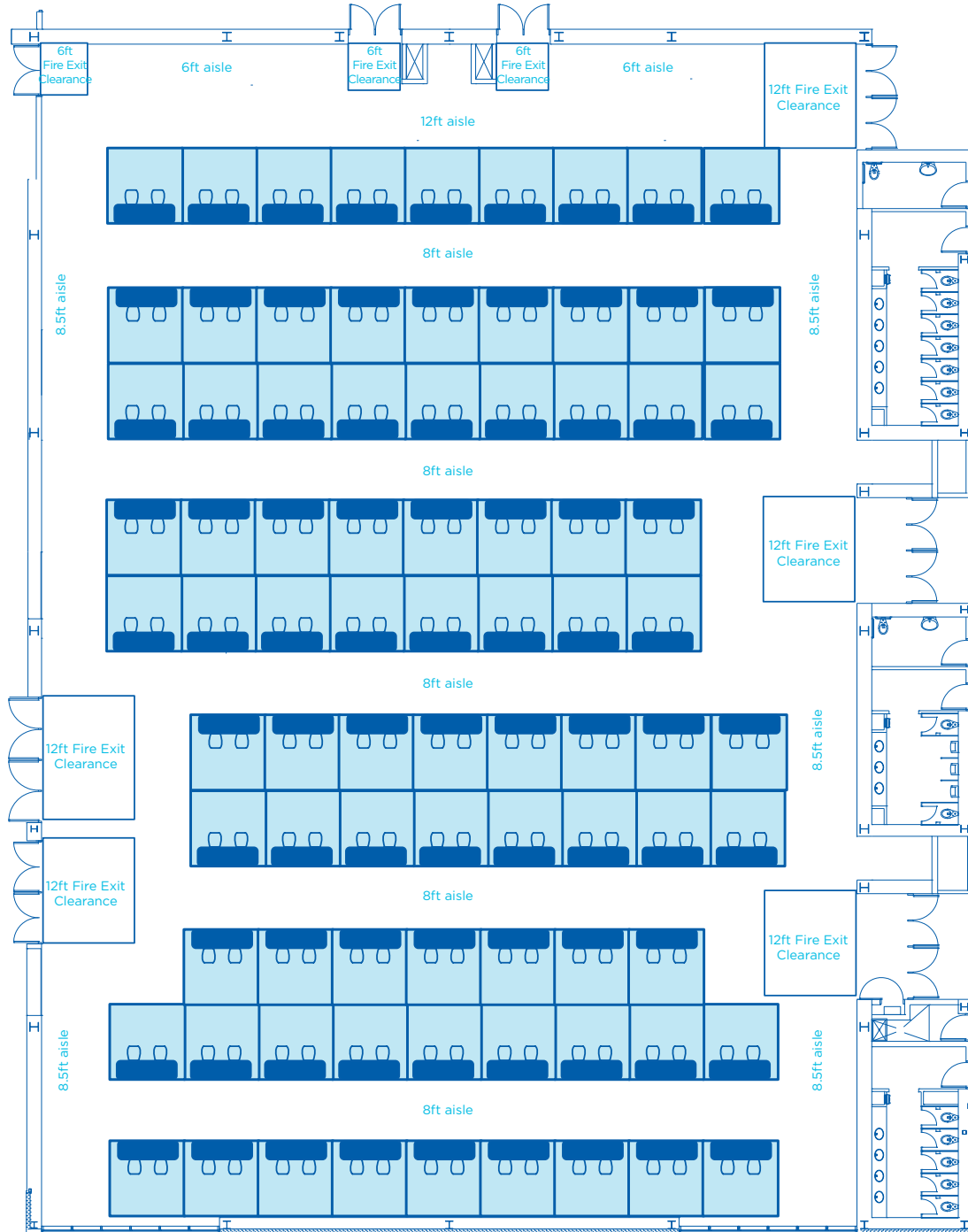

AREA FT ²	AREA M ²	DIMENSIONS FT	CEILING HEIGHT FT	BANQUET 66" OF 10*	RECEPTION*	THEATRE*	CLASSROOM*	BOOTHS 10 x 10*	BOOTHS 8 x 10*
16,955	1,575	108 x 156	23'9"	1,080	2,100	1,722	900	84	92

*Information listed are maximum 'guest capacities' and may change based on staging, AV equipment, and F&B stations.

plan to be impressed.

Click [here](#) to view all floorplans

BALLROOM ABCD

Max 8x10 Booths - 92 booths

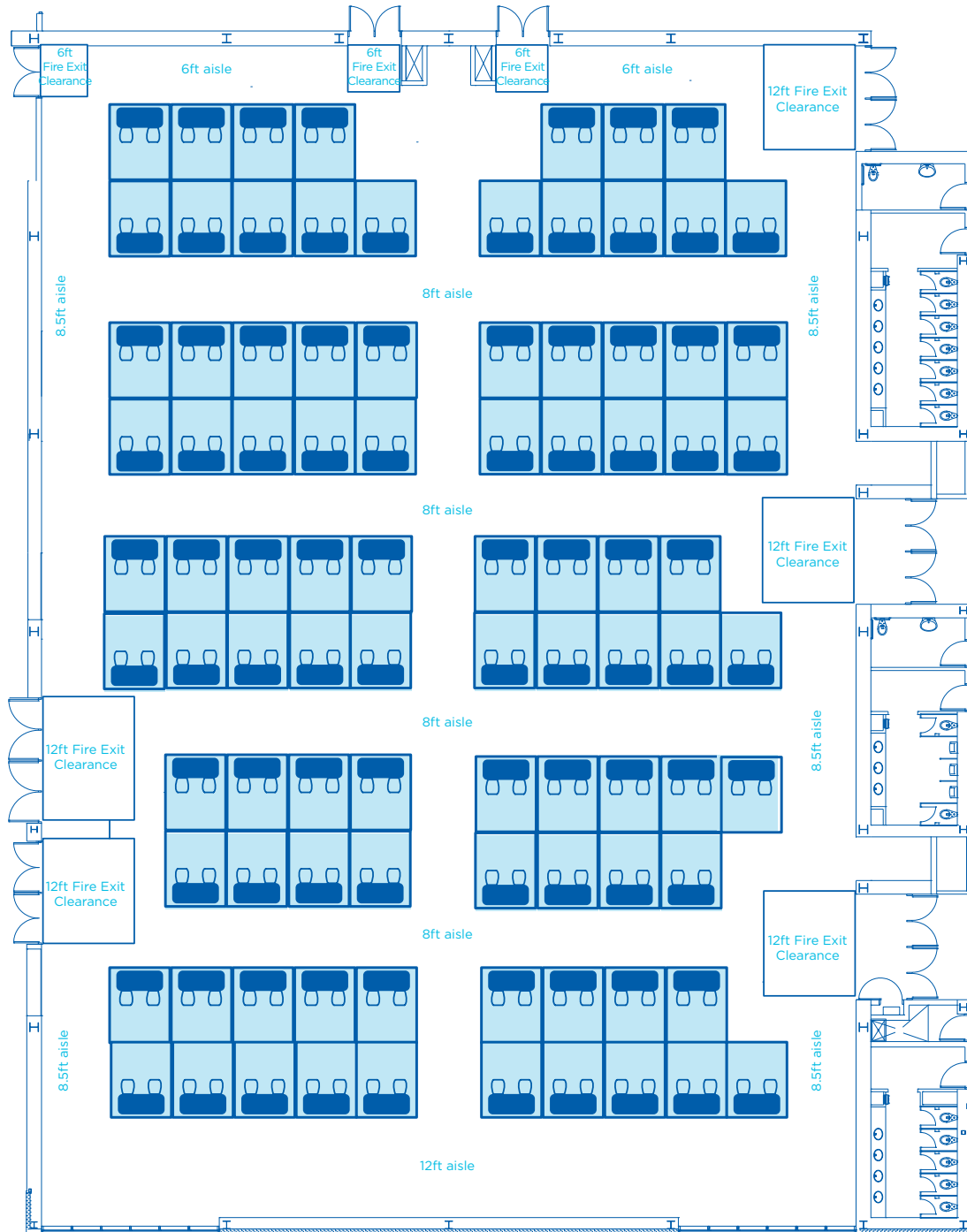

AREA FT ²	AREA M ²	DIMENSIONS FT	CEILING HEIGHT FT	BANQUET 66" OF 10*	RECEPTION*	THEATRE*	CLASSROOM*	BOOTHS 10 x 10*	BOOTHS 8 x 10*
16,955	1,575	108 x 156	23'9"	1,080	2,100	1,722	900	84	92

*Information listed are maximum 'guest capacities' and may change based on staging, AV equipment, and F&B stations.

plan to be impressed.

Click [here](#) to view all floorplans