

BALLROOM ABC

Max Theatre Style - 1027 people

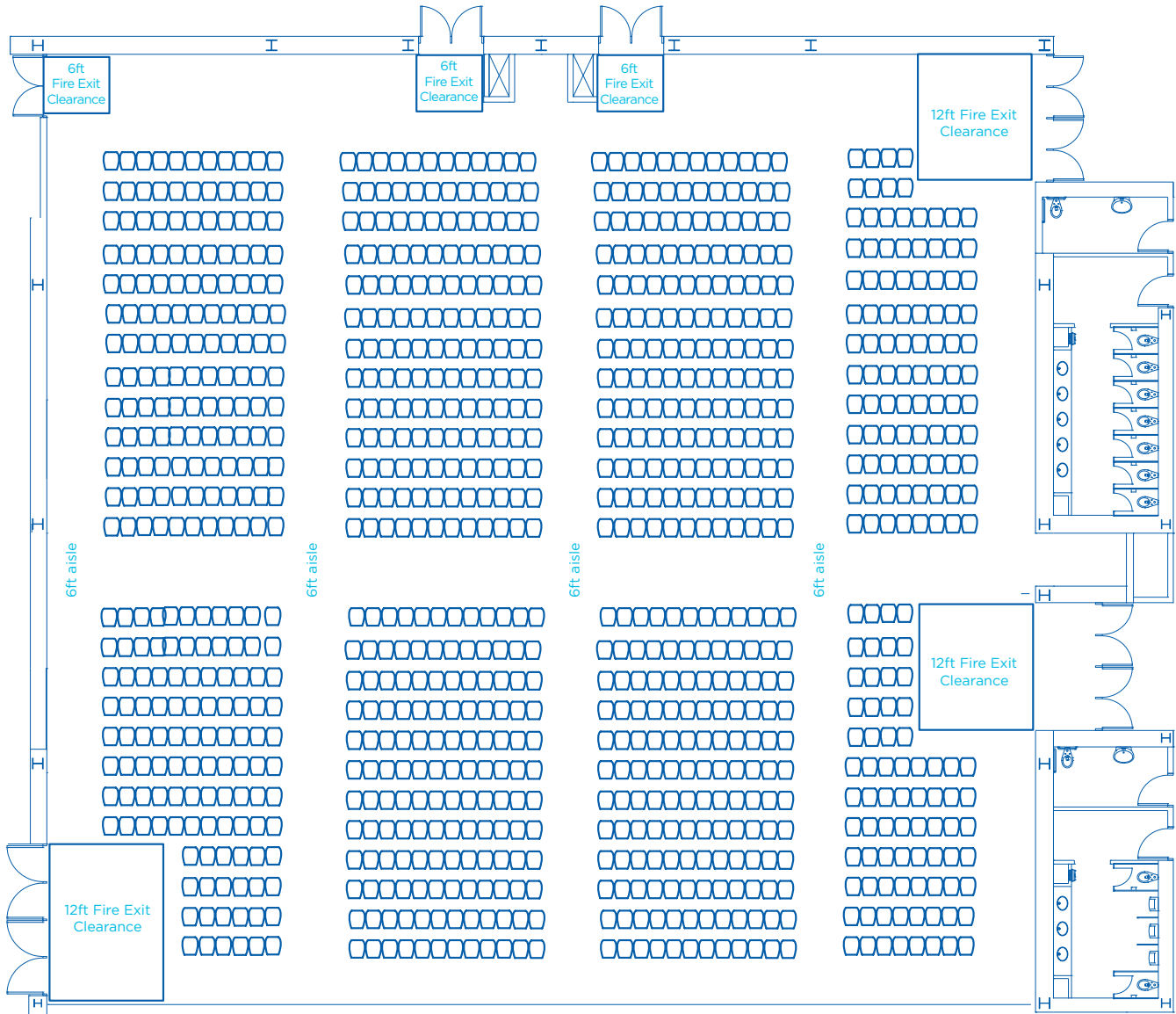

| AREA FT ² | AREA M ² | DIMENSIONS FT | CEILING HEIGHT FT | BANQUET 66" OF 10* | RECEPTION* | THEATRE* | CLASSROOM* | BOOTHS 10 x 10* | BOOTHS 8 x 10* |
|-------------------------|------------------------|------------------|----------------------|-----------------------|------------|----------|------------|--------------------|-------------------|
| 11,240 | 1,044 | 108 x 104 | 23'9" | 700 | 1,400 | 1,027 | 572 | 57 | 67 |

*Information listed are maximum 'guest capacities' and may change based on staging, AV equipment, and F&B stations.

plan to be impressed.

Click [here](#) to view all floorplans

BALLROOM ABC

Max Classroom Style - 572 people

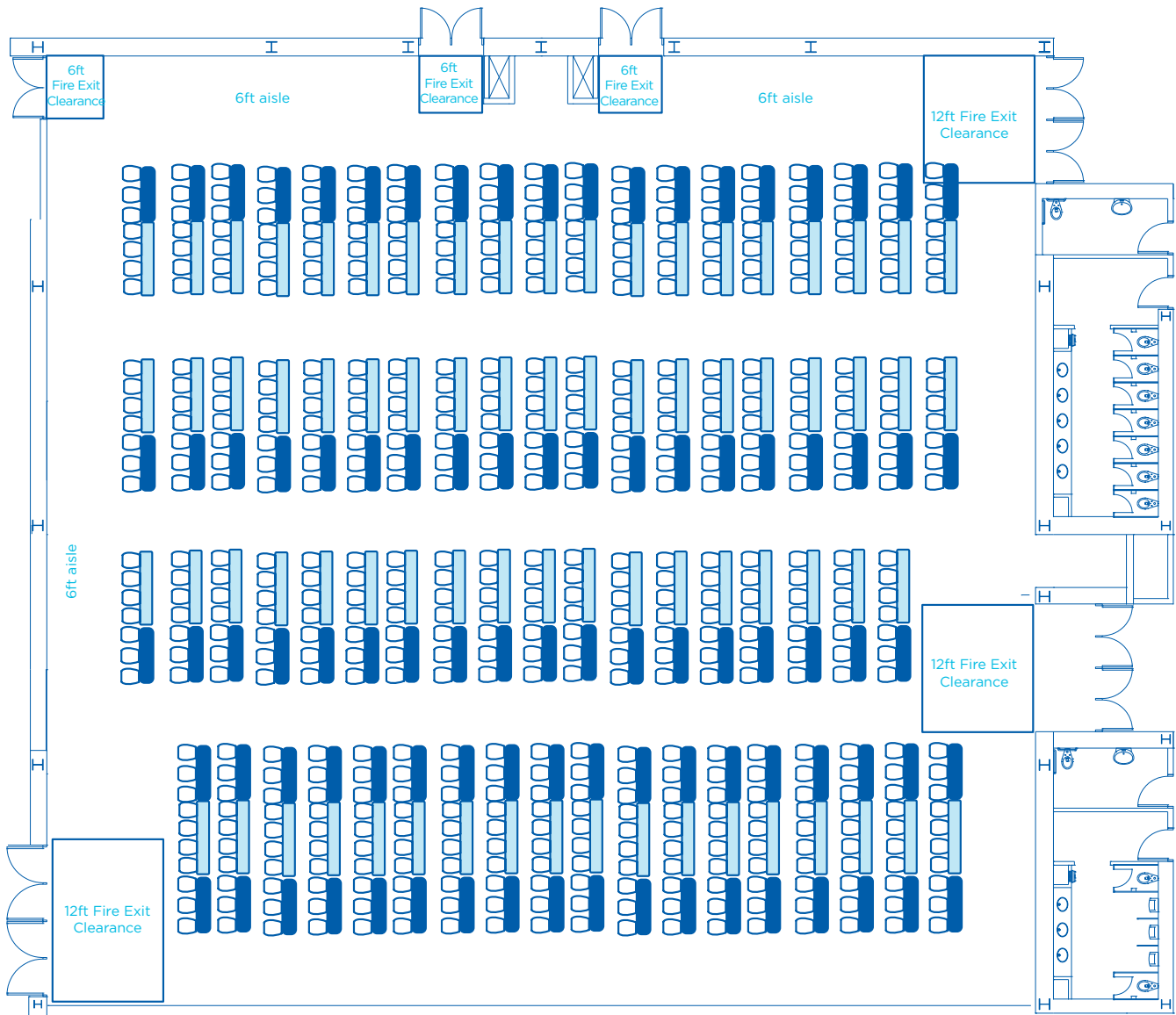

| AREA FT ² | AREA M ² | DIMENSIONS FT | CEILING HEIGHT FT | BANQUET 66" OF 10* | RECEPTION* | THEATRE* | CLASSROOM* | BOOTHS 10 x 10* | BOOTHS 8 x 10* |
|-------------------------|------------------------|------------------|----------------------|-----------------------|------------|----------|------------|--------------------|-------------------|
| 11,240 | 1,044 | 108 x 104 | 23'9" | 700 | 1,400 | 1,027 | 572 | 57 | 67 |

*Information listed are maximum 'guest capacities' and may change based on staging, AV equipment, and F&B stations.

plan to be impressed.

Click [here](#) to view all floorplans

BALLROOM ABC

Max 66" Rounds of 10 – 700 people

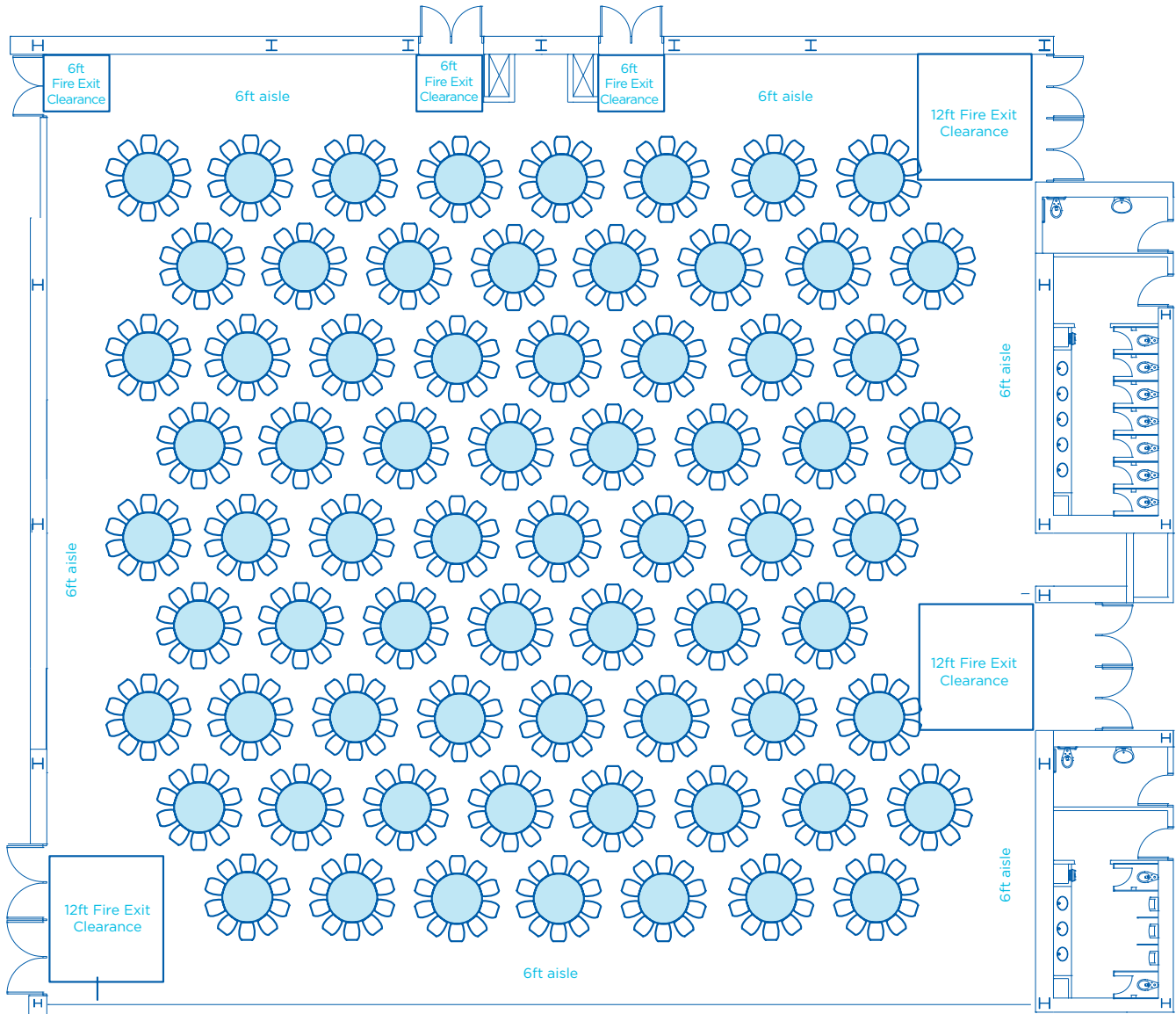

| AREA FT ² | AREA M ² | DIMENSIONS FT | CEILING HEIGHT FT | BANQUET 66" OF 10* | RECEPTION* | THEATRE* | CLASSROOM* | BOOTHS 10 x 10* | BOOTHS 8 x 10* |
|-------------------------|------------------------|------------------|----------------------|-----------------------|------------|----------|------------|--------------------|-------------------|
| 11,240 | 1,044 | 108 x 104 | 23'9" | 700 | 1,400 | 1,027 | 572 | 57 | 67 |

*Information listed are maximum 'guest capacities' and may change based on staging, AV equipment, and F&B stations.

plan to be impressed.

Click [here](#) to view all floorplans

BALLROOM ABC

Max 10x10 Booths - 57 booths

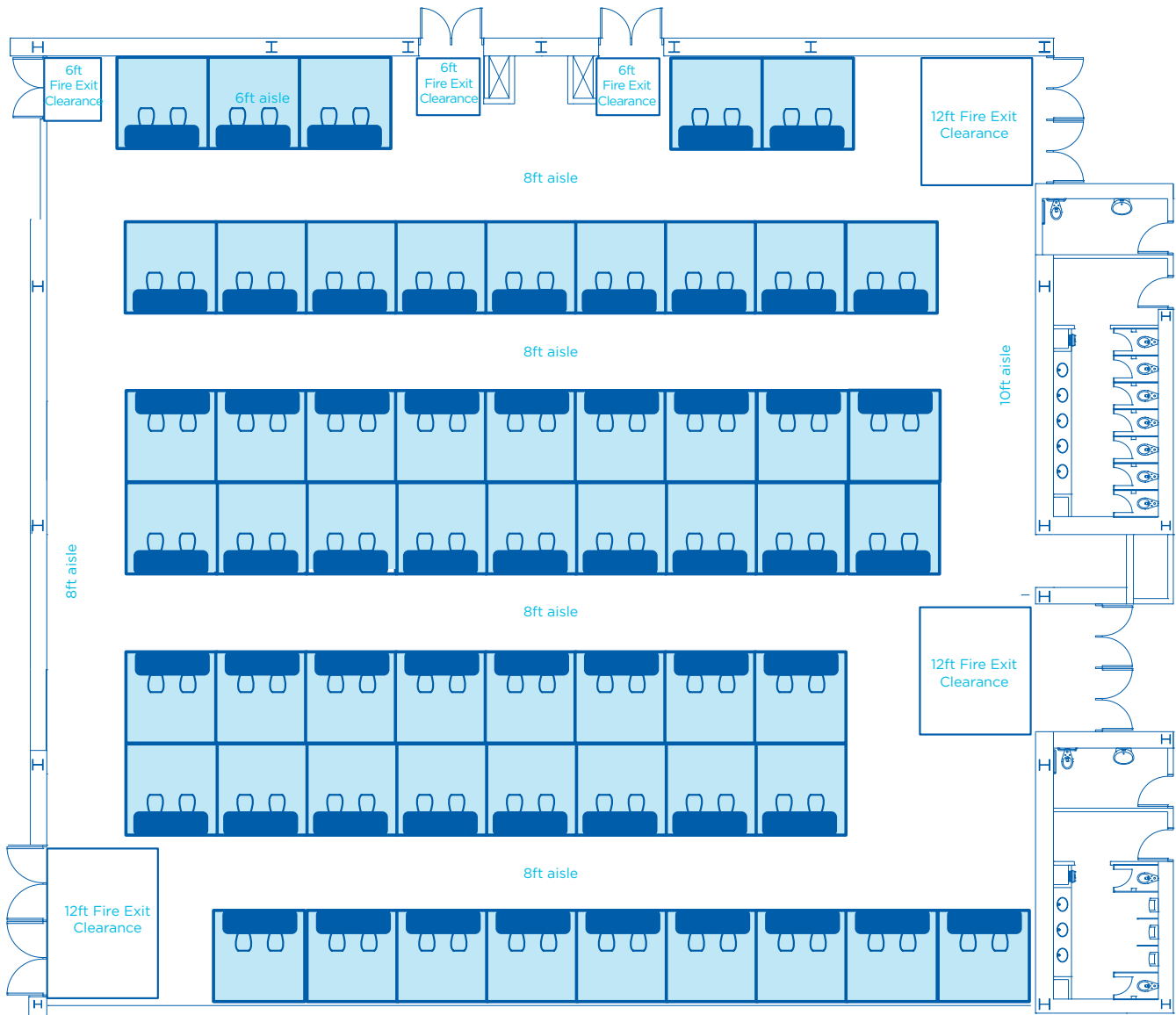

| AREA FT ² | AREA M ² | DIMENSIONS FT | CEILING HEIGHT FT | BANQUET 66" OF 10* | RECEPTION* | THEATRE* | CLASSROOM* | BOOTHS 10 x 10* | BOOTHS 8 x 10* |
|-------------------------|------------------------|------------------|----------------------|-----------------------|------------|----------|------------|--------------------|-------------------|
| 11,240 | 1,044 | 108 x 104 | 23'9" | 700 | 1,400 | 1,027 | 572 | 57 | 67 |

*Information listed are maximum 'guest capacities' and may change based on staging, AV equipment, and F&B stations.

plan to be impressed.

Click [here](#) to view all floorplans

BALLROOM ABC

Max 8x10 Booths - 67 booths

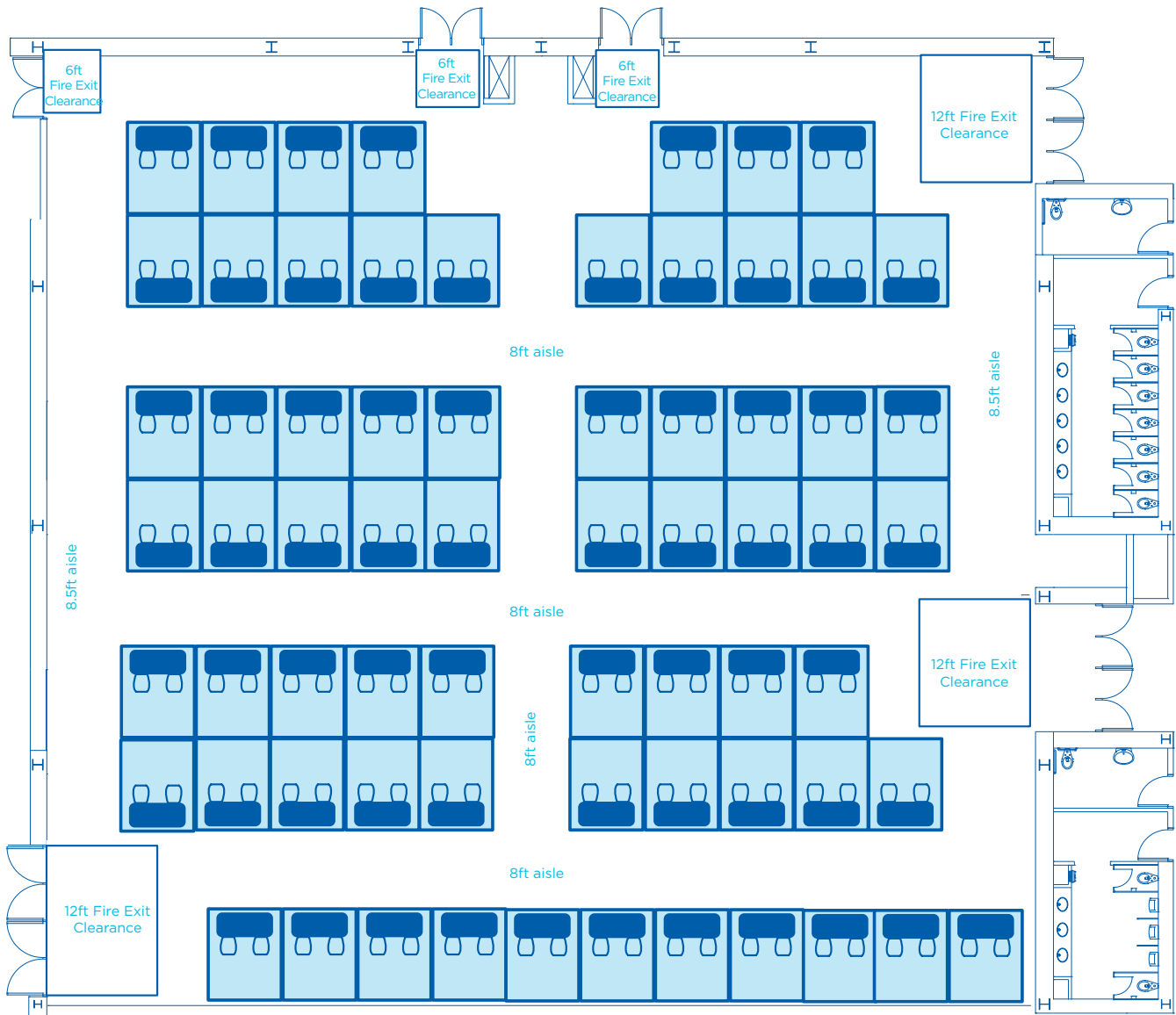

| AREA FT ² | AREA M ² | DIMENSIONS FT | CEILING HEIGHT FT | BANQUET 66" OF 10* | RECEPTION* | THEATRE* | CLASSROOM* | BOOTHS 10 x 10* | BOOTHS 8 x 10* |
|-------------------------|------------------------|------------------|----------------------|-----------------------|------------|----------|------------|--------------------|-------------------|
| 11,240 | 1,044 | 108 x 104 | 23'9" | 700 | 1,400 | 1,027 | 572 | 57 | 67 |

*Information listed are maximum 'guest capacities' and may change based on staging, AV equipment, and F&B stations.

plan to be impressed.

Click [here](#) to view all floorplans