

BALLROOM AB

Max Theatre Style – 555 people

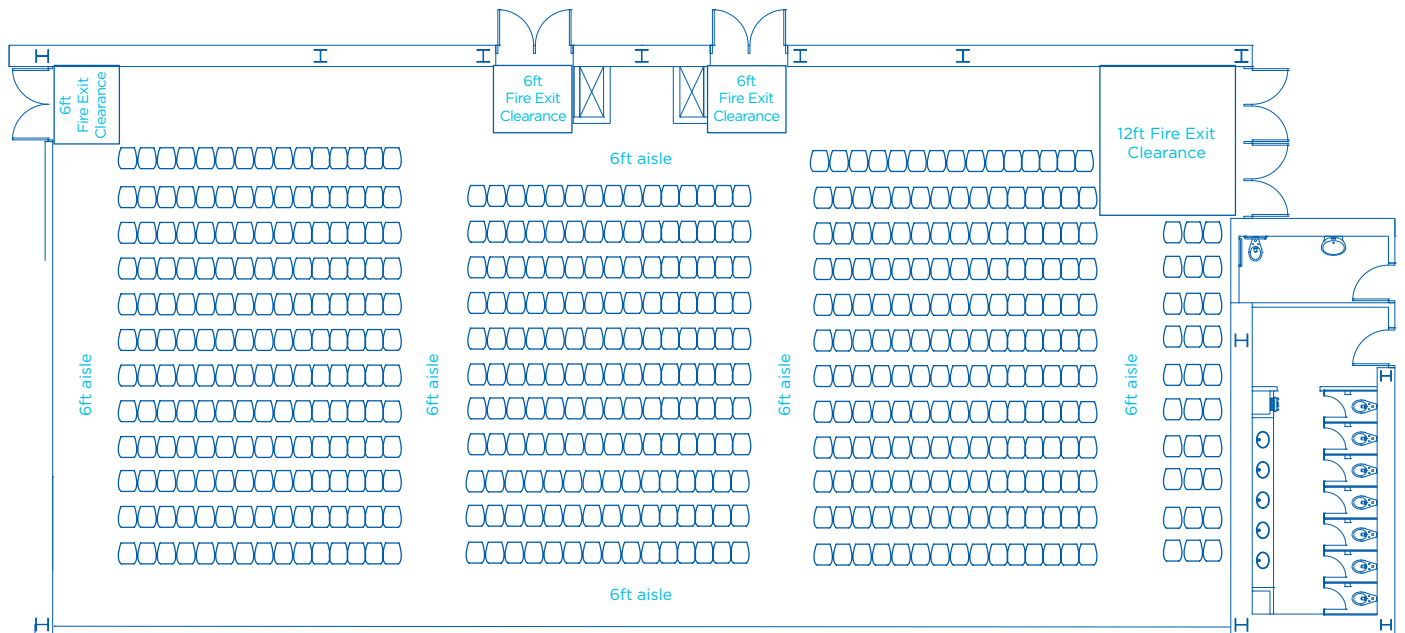

AREA FT ²	AREA M ²	DIMENSIONS FT	CEILING HEIGHT FT	BANQUET 66" OF 10*	RECEPTION*	THEATRE*	CLASSROOM*	BOOTHS 10 x 10*	BOOTHS 8 x 10*
5,500	511	108 x 52	23'9"	320	700	555	339	32	31

*Information listed are maximum 'guest capacities' and may change based on staging, AV equipment, and F&B stations.

plan to be impressed.

Click [here](#) to view all floorplans

BALLROOM AB

Max Classroom Style – 339 people

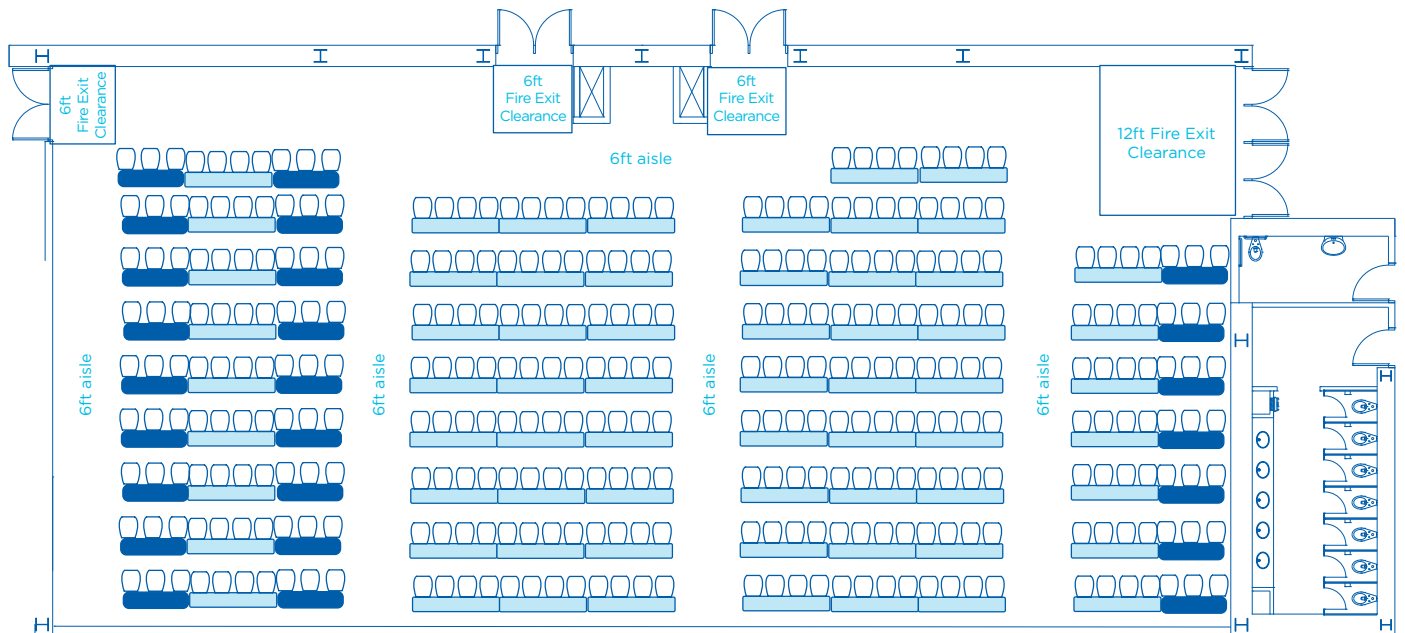

AREA FT ²	AREA M ²	DIMENSIONS FT	CEILING HEIGHT FT	BANQUET 66" OF 10*	RECEPTION*	THEATRE*	CLASSROOM*	BOOTHS 10 x 10*	BOOTHS 8 x 10*
5,500	511	108 x 52	23'9"	320	700	555	339	32	31

*Information listed are maximum 'guest capacities' and may change based on staging, AV equipment, and F&B stations.

plan to be impressed.

Click [here](#) to view all floorplans

BALLROOM AB

Max 66" Rounds of 10 – 320 people

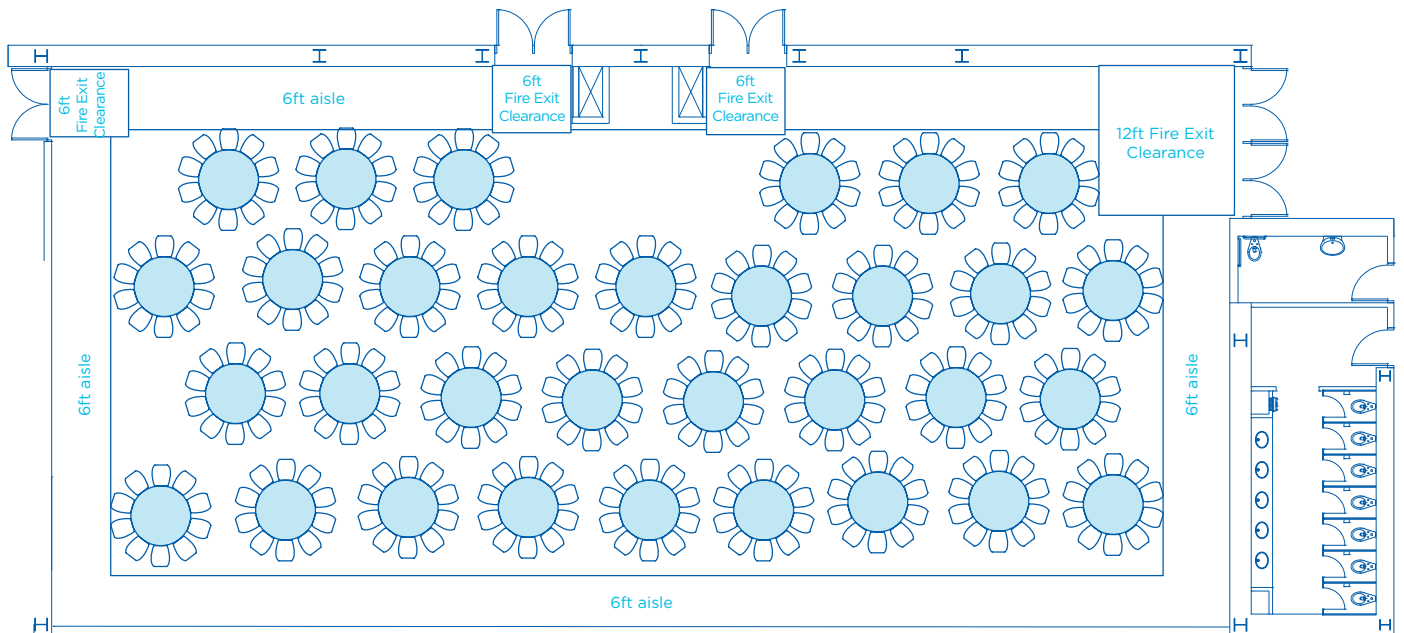

AREA FT ²	AREA M ²	DIMENSIONS FT	CEILING HEIGHT FT	BANQUET 66" OF 10*	RECEPTION*	THEATRE*	CLASSROOM*	BOOTHS 10 x 10*	BOOTHS 8 x 10*
5,500	511	108 x 52	23'9"	320	700	555	339	32	31

*Information listed are maximum 'guest capacities' and may change based on staging, AV equipment, and F&B stations.

plan to be impressed.

Click [here](#) to view all floorplans

BALLROOM AB

Max 10x10 Booths – 32 booths

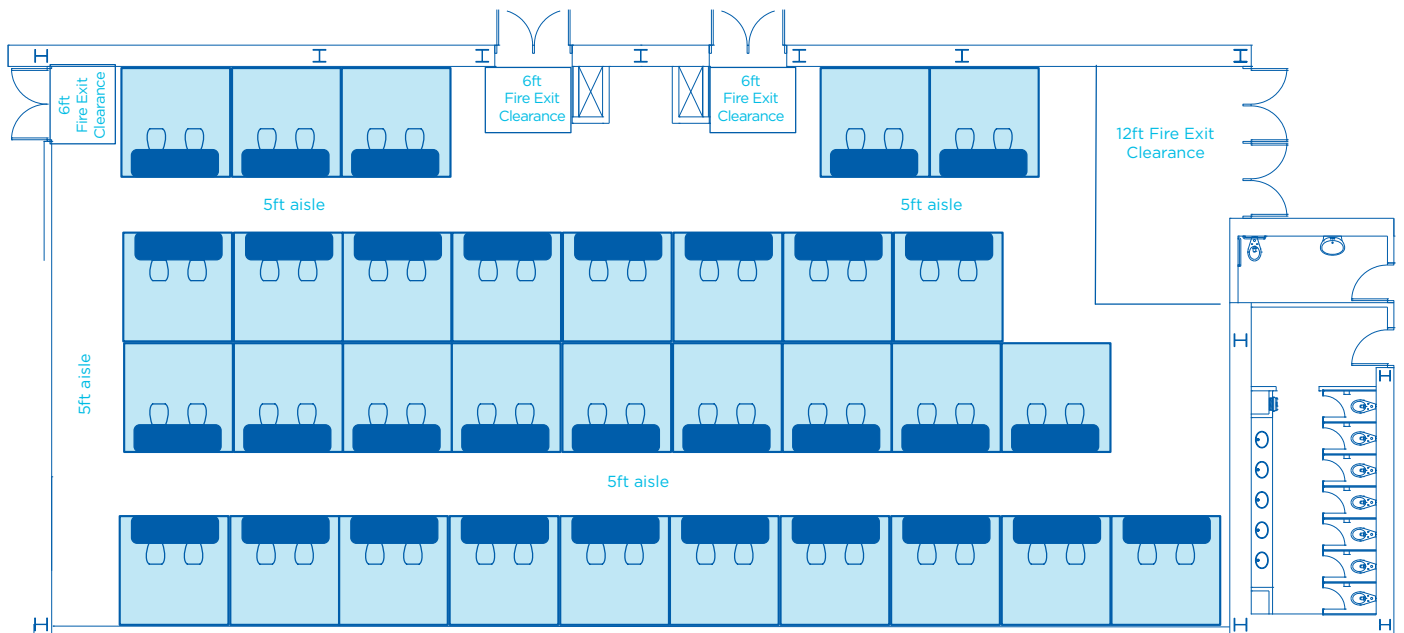

AREA FT ²	AREA M ²	DIMENSIONS FT	CEILING HEIGHT FT	BANQUET 66" OF 10*	RECEPTION*	THEATRE*	CLASSROOM*	BOOTHS 10 x 10*	BOOTHS 8 x 10*
5,500	511	108 x 52	23'9"	320	700	555	339	32	31

*Information listed are maximum 'guest capacities' and may change based on staging, AV equipment, and F&B stations.

plan to be impressed.

Click [here](#) to view all floorplans

BALLROOM AB

Max 8x10 Booths - 31 booths

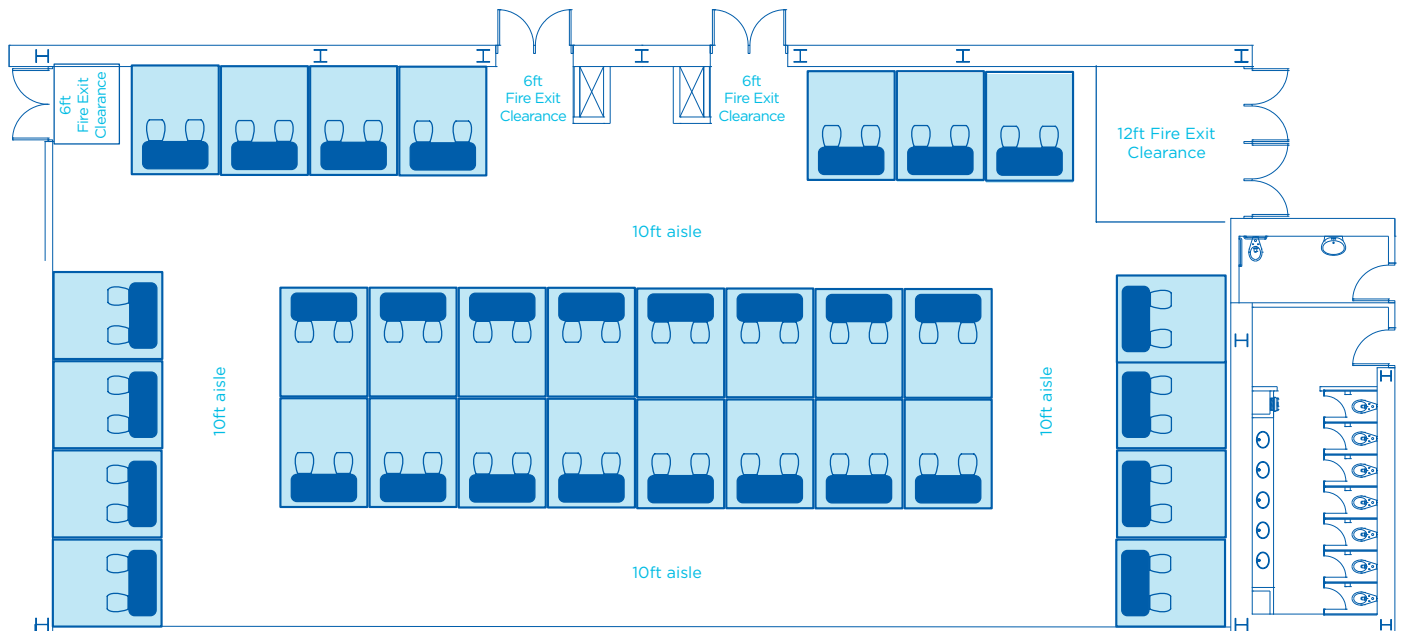

AREA FT ²	AREA M ²	DIMENSIONS FT	CEILING HEIGHT FT	BANQUET 66" OF 10*	RECEPTION*	THEATRE*	CLASSROOM*	BOOTHS 10 x 10*	BOOTHS 8 x 10*
5,500	511	108 x 52	23'9"	320	700	555	339	32	31

*Information listed are maximum 'guest capacities' and may change based on staging, AV equipment, and F&B stations.

plan to be impressed.

Click [here](#) to view all floorplans